

NOTE 1—Tillers numbered 24574 & below used drag bar #1116 for the depth regulating assembly with spacer bushings #1113, two 5/16" flat washers #9902, two #9912 lock washers, and two #9705 hex. head screws. To use old style #1116 depth reg. drag bar on new transmission, break off the welded tab on transmission tube — where #9710 bolt attaches #4763, drag bar.

NOTE 2—Part #9142 wheel assembly may be used with Tiller Serial No's. 31041 & Up provided wheel shaft (Part #1025) has two holes on each end of shaft. For Tiller Serial No's. 31455 & Below, see Page 17, Index 3. For Bar Tread Tires, see Page 16, Index No's. 1 or 13.

INDEX NO.	PART NO.	DESCRIPTION	NO. REQ'D	REPLACES
TILLER, TINES, HOOD, WHEELS, DEPTH REGULATOR				
1	9142	WHEEL ASSEMBLY—standard tread, 4:00/4:80 x 8 tubeless tire and valve stem, mounted on single-piece steel wheel. Used on tillers with Part #1235 or 1878 wheel shaft for Tiller Serial #31456 & Up. (see Note 2, Page 14)	2
2	CASE—transmission housing & tube assy. (Contact service dept.)	1
3	9500	RING—retaining (snap ring external, transmission drive pulley)	2	1109
4	1008-1	PULLEY—matched belts, transmission drive, cast iron, Tiller Serial #4333 & Up. Prior to Serial #5984, pulleys were aluminum	1	1008A
4A	1008	PULLEY—single belt, variable speed, tiller serial No. 4332 & below, 4½ H.P. maximum	1
4B	1484	PULLEY—transmission drive, cast iron, uses single belt, and rubber rimmed reverse disc	1	1008-1
5	9301	KEY—3/16" square x 1" long, pulley to drive shaft	1	1101, 9302
6	9322	PIN—roll (spiral), 5/16" x 1½" long wheel hub to shaft	2	1097
7	9713	BOLT—¾"-16 x 1½", see page 4, Index 66	4
8	9913	LOCKWASHER—¾", see page 4, Index 67	4
9	9710	BOLT—hex. head, ¾"-16 x 1", belt adj. block, depth regulator	3
10	9913	LOCKWASHER—¾"	3
11	9903	WASHER—flat, ¾", regular standard	1
12	1077	BRACKET—hood, front, belt adj. block, & stud for wheel shift lever	1
13	1920	BLOCK—belt adjustment, 3¾" long, for four-speed tillers, Serial #314151 & Up. Includes Index #'s 9, 10, 11 & 39. Use with Part #1921 engine yoke or #1487 engine yoke (with tab removed)—see Page 21, Index 7	1	1133-1A
13A	1133-1A	BLOCK—belt adjustment, 3¾" long, for two-speed tillers, Serial #314150 & Below. Has cast-in Neutral position. Replaces ¾" steel bar (completely flat) used previously. Includes Index #'s 9, 10 & 11.	1	1133
14	9802	NUT—hex, ¾"-16	2
15	1519	HOOD—tine cover with hinged flap, includes hood decals	1	1082
16	9119	KNOB—with spring retainer. Also see Index #20A, Page 23	1
17	1117A	BAR—depth adjustment, includes Knob, Index #16	1	1117
18	1076	BRACKET—hood, rear (includes roll pin, Part #9308)	1
19	9723	SCREW—round head, ¼"-20 x ¾"	4
20	9910	LOCKWASHER—¼"	4
21	9800	NUT—hex., ¼"-20	4
22	1113-1	BUSHING—spacer, drag bar, also see Page 24, Index #53	2
23	4763	DRAG BAR—depth regulator, tiller serial No. 24575 & up (see note 1)	1	1116
23A	1116	DRAG BAR—depth regulator, tiller serial No. 24574 & below. See page 41, Index 5, also Note 1, page 14.		
24	9703	BOLT—hex. head 5/16"-18 x ¾"	6
25	9912	LOCKWASHER—5/16"	6
26	9801	NUT—hex, 5/16"-18	2
27	1119	PLUNGER—depth regulator locking	1
28	1120	SPRING—depth reg. plunger	1
29	9726	PLUG—pipe ¼", see page 4, Index 68A	1
30	BOLO TINE ASSEMBLY, RIGHT (see page 18)
31	9301	KEY—3/16" square x 1", tine shaft	2
32	See Tine Assemblies, Pages 18 & 19		
33	9145	HUB CAP—wheel	2
34	1138-1	SHIM—transmission pulley, 1/16" thickness	as req'd
35	9902	WASHER—flat, 5/16" S.A.E., O.D. 11/16"	2
36	9712	BOLT—hex. head, ¾"-16 x 1¼"	1	9710
37	1239	DECAL—hood, operating instructions for 6 & 8HP engines. 7HP Kohler engine owners specify Part #2156 decal	1
38	1238	DECAL—Troy-Bilt, 3" x 7½"	1
39	2100	ROD—belt adjustment, 7" long, with measuring gauge. For use with Part #1920 (Index #13) adjustment block	1

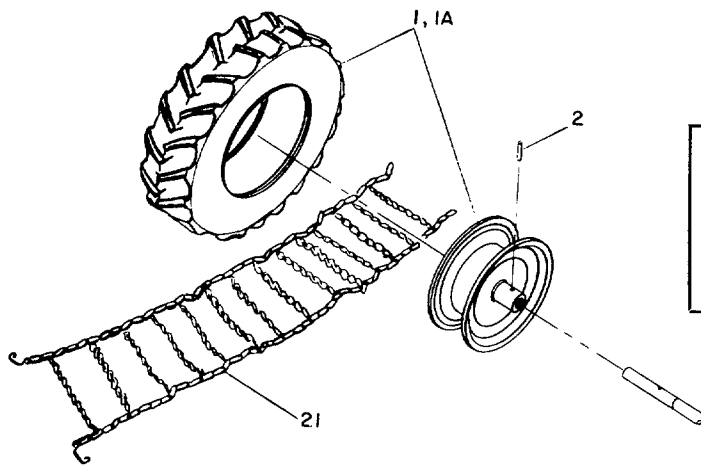

PLEASE NOTE: Part #'s 9143 & 9144 (tubeless Bar Treads) must be a matched pair. When ordering a replacement wheel & tire, please specify the manufacturer's name on the tire you're keeping (such as Goodyear, or McCreary, etc.). Thank you.

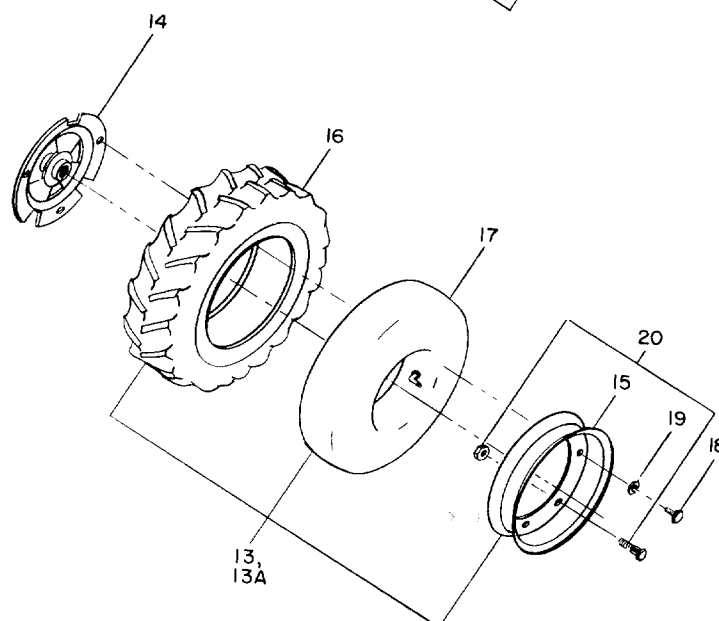
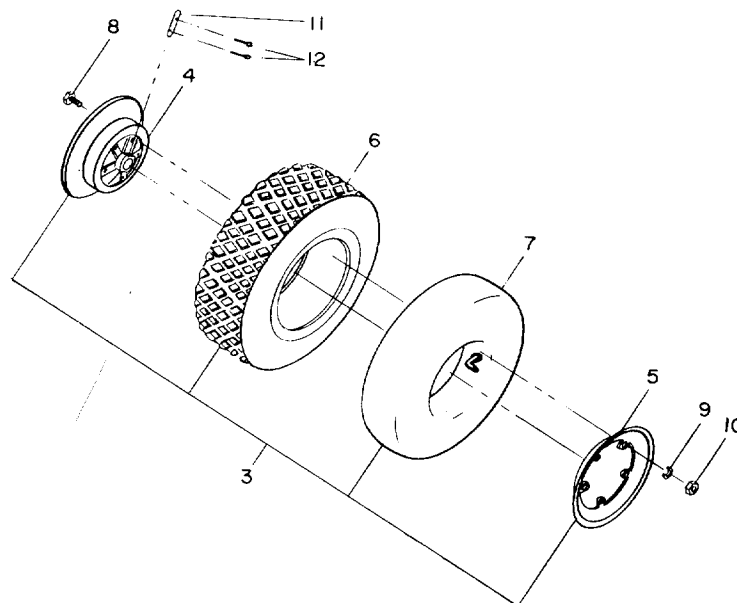

INDEX NO.	PART NO.	DESCRIPTION	NO. REQ'D	REPLACES
TWO-PIECE CAST IRON WHEELS, TIRE OPTIONS, CHAINS				
1	9144*	WHEEL ASSEMBLY—Bar Tread Tire, RIGHT SIDE, 4:80 x 8 tubeless tire mounted on single piece wheel, use with #1878 or #1235A wheel shaft, tiller No.'s 31456 & Up (optional)	1
1A	9143*	WHEEL ASSEMBLY—Bar Tread Tire, LEFT SIDE, (same as #9144, except left) use with #1235A or #1878 wheel shaft	1
2	9322	PIN—roll, (spiral), 5/16" x 1½"	2
3	9148	WHEEL ASSEMBLY—4:00 x 7 wheel, tire & tube, complete, cast iron, two piece, use with #1879 or #1025 wheel shaft (order wheel pins & cotter pins separately). Use for tiller No.'s 31040 & below, left & right are interchangeable	2
4	1018	WHEEL & HUB—7", cast iron, goes with #1017 & standard tread tire, requires 5 bolts, washers & nuts. Use with #1879 or #1025 wheel shaft, tiller No.'s 31040 & below	2
5	1017	RIM—wheel, 7", use with #1018 wheel & hub	2
6	9109	TIRE—standard tread, 4:00 x 7, tube type	2
7	9110	TUBE—4:00 x 7	2
8	9712	BOLT—hex. head ¾"—16 x 1¼", 5 per wheel	10
9	9913	LOCKWASHER—¾", 5 per wheel	10
10	9802	NUT—hex, ¾"—16, 5 per wheel	10
11	1097	PIN—wheel drive	2
12	9317	COTTER PIN—retains wheel pin, 3/32" x 1", 2 per wheel	4
13	9149*	WHEEL ASSEMBLY—4:00 x 8 Bar Tread wheel & tire, tube type, assembled, LEFT SIDE with hub, includes Index No.'s 14, 15 (pair), 16, 17 & 20, and three bolts & washers. Use with #1879 or #1025 wheel shaft, tiller No.'s 31040 & below	1
13A	9150*	WHEEL ASSEMBLY—4:00 x 8 Bar Tread, same as above, except RIGHT SIDE	1
14	1163	HUB—wheel, 8", cast iron, use with tube type Bar Tread Tire, included with Index 13 & 13A.	2
15	9113	RIM—wheel, 4:00 x 8, two piece unit, includes 3 assembly studs (see Index 20) & 3 mounting bolts & washers	2
16	9111	TIRE—Bar Tread 4:00 x 8, tube type. For tillers prior to serial No. 6186 using 5 x 8 Bar Treads, substitute 4 x 8 Bar Treads, or obtain replacement 5 x 8 tire locally	2
17	9112	TUBE—4:00 x 8, for Bar Tread Tire	2
18	9709	BOLT—hex head, ¾"—16 x ¾", 3 per wheel, for mounting	6
19	9913	LOCKWASHER—¾", 3 per wheel	6
20	STUD & NUT—fastens 2-piece rim together to make #9113 rim, 3 per wheel, not sold separately	6
21	9146	CHAINS—tire, 4:80/4:00 x 8, fits #9143 & 9144, or #9142 standard tire, set. Tiller serial No.'s 26000 up to 31455 can use chains with tube type bar tread tires #9111	1

***PLEASE NOTE—**

Bar Tread Tires are mounted on Troy-Bilt Horse so that the arrow on the side of the tire points in the direction of FORWARD rotation of the wheel. With tires mounted in this manner, the closed end of the "V" in the tire tread on top of the tire will face forward.

BOLO TINES ASSEMBLIES (Viewed From Front Of Tiller)

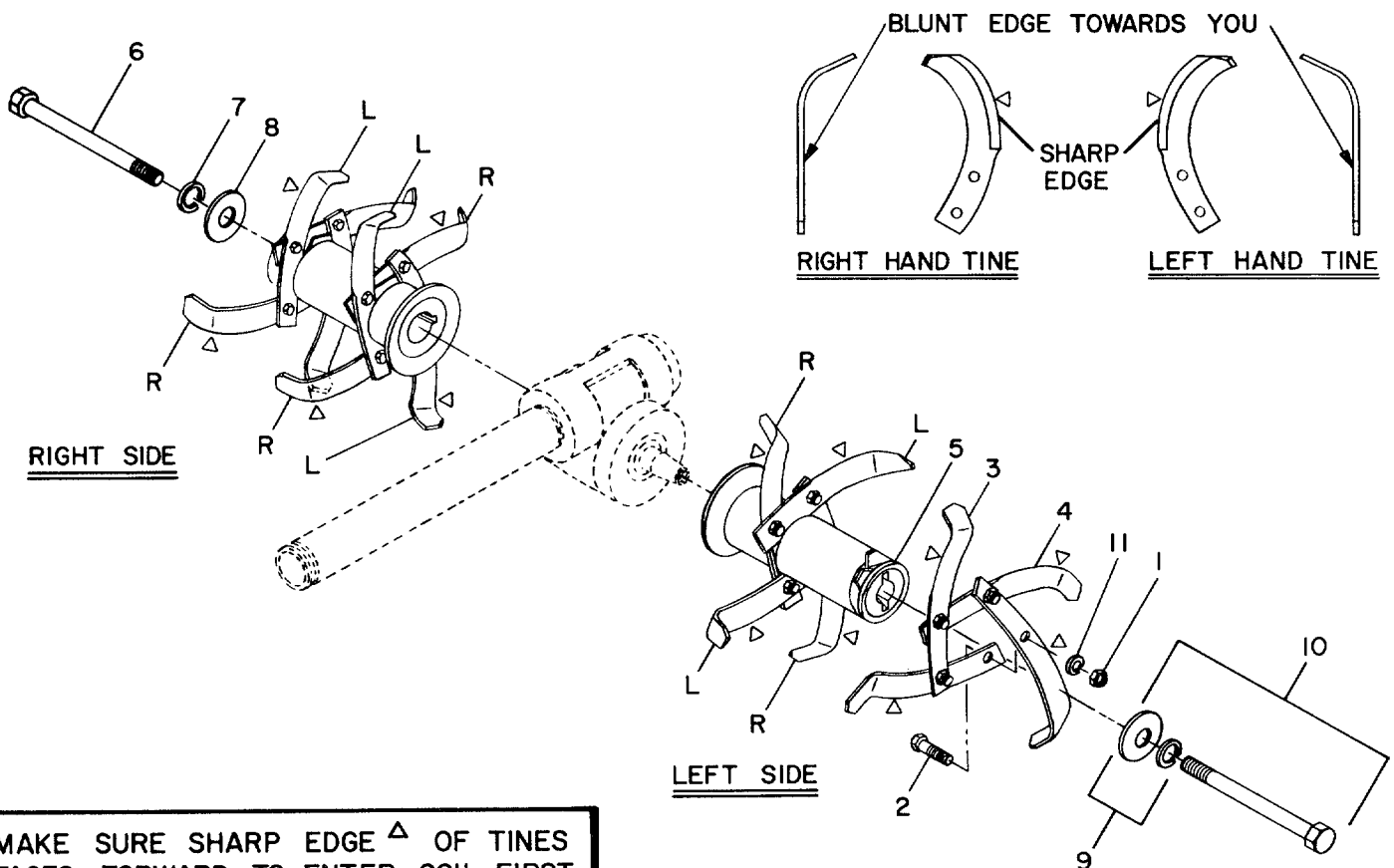

MAKE SURE SHARP EDGE Δ OF TINES
FACES FORWARD TO ENTER SOIL FIRST

OLD-STYLE TINE HOLDER MOUNTING ARRANGEMENT

Beginning with Tiller Serial No. 308889, all tillers have been equipped with the new-style Bolo Tine holder mounting bolt and washer set shown at Index No. 10, above. This mounting arrangement makes it much easier to remove and replace the holders, if necessary.

As a result, we no longer stock the old-style, Part #1206 mounting stud (threaded on both ends), that is shown at Index No. 11, below. If you ever need to replace a #1206 stud, or if you simply want to update your tiller, you should order the Part #1735 bolt and washer set shown at Index No. 10, above (order two #1735's if you're replacing both studs).

We do, however, still stock the washers and nut that are used with the #1206 stud. Those items are shown below at Index No's. 12, 13, 14 & 15.

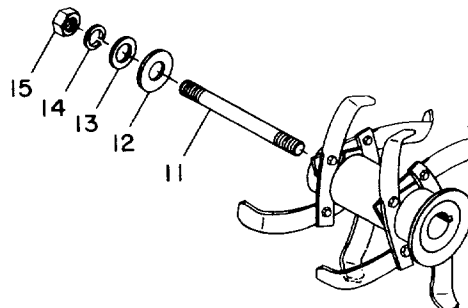

INDEX NO.	PART NO.	DESCRIPTION	NO. REQ'D	REPLACES
BOLO TINE ASSEMBLIES				
1	9802	NUT—hex., $\frac{3}{8}$ "-16, tine mounting	16	9807
2	9711	BOLT—hex. hd., $\frac{3}{8}$ "-16 x 1", tine mounting	16
3	1270-2A	BOLO TINE—single, RIGHT HAND tine used on left and right side bolo assemblies. Tine is stamped "ER" or "AR". Includes replacement hardware—two #9711 bolt, two #9913 lockwasher, & two #9802 hex nut. NOTE: These tines won't fit chopper tine holders	8	1142-2, 1270-R
4	1270-1A	BOLO TINE—single, LEFT HAND tine used on left and right side bolo assemblies. Tine is stamped "EL" or "AL". Includes same replacement hardware described for right hand tine above	8	1142-1, 1270-L
5	1205	HOLDER—Bolo Tines, for either side of tiller, each holder uses four left and four right hand tines	2
6	1463	BOLT— $\frac{1}{2}$ "-20 x $5\frac{3}{4}$ ", threaded on one end, mounts bolo holder on tine shaft. For all Horse Model tillers, use with Part No's. 9914 & 1461. Replaces #1206 mounting stud (Index #11)	2	9805, 1206
7	9914	LOCKWASHER— $\frac{1}{2}$ "	2
8	1461	WASHER—flat, $\frac{17}{32}$ ", outer dia. $1\frac{3}{4}$ "	2	9905, 9908
9	1207A	WASHER SET—for Part No. 1463 bolt. Includes two #9914 lockwashers (Index #7) and two #1461 washers (Index #8)	1 Set
10	1735	BOLT & WASHER SET—includes one #1463 mounting bolt (Index #6), one #9914 lockwasher (Index #7) and one #1461 washer (Index #8)	2 Sets
11	9913	LOCKWASHER— $\frac{3}{8}$ ", tine mounting	16
....	1246	BOLO TINE ASSEMBLIES—16 tines completely assembled on holders and ready to install on tiller. Includes two #1205 holders; 8 left hand and 8 right hand tines; hardware for tine mounting (16 bolts, lockwashers, nuts); hardware for holder mounting (2 each bolts, lockwashers, plain washers) and two #9301 tine shaft keys (see Page 14, Index #31)	1
....	1245K	SET OF 16 BOLO TINES WITH REPLACEMENT HARDWARE—unassembled. Includes 8 left hand and 8 right hand tines; hardware for tine mounting (16 each #9711 bolts, #9913 lockwashers, #9802 hex nuts). Does not include tine holders, holder mounting bolts, or tine shaft keys	1

OLD-STYLE TINE HOLDER MOUNTING ARRANGEMENT

11	1206	STUD— $\frac{1}{2}$ "-20 x 6", threads on both ends. NO LONGER AVAILABLE. Replace with Part #1735 bolt and washer set, Index #10	2
12	9908	WASHER—flat, $\frac{5}{8}$ " standard size, outer diameter $1\frac{3}{4}$ "	2
13	9905	WASHER—flat, $\frac{1}{2}$ " O.D. $1\frac{3}{8}$ "	2
14	9914	LOCKWASHER— $\frac{1}{2}$ "	2
15	9805	NUT—hex $\frac{1}{2}$ "-20, tine holder & stud to tine shaft	2

PLEASE NOTE—Left and right sides of tiller are determined by standing in the operator position and facing the direction of forward travel.

SPECIAL PARTS FOR
FOUR SPEED HORSE MODEL

SEE PAGE 22 FOR ALL PARTS
OTHER THAN THE NINE PARTS
IDENTIFIED HERE

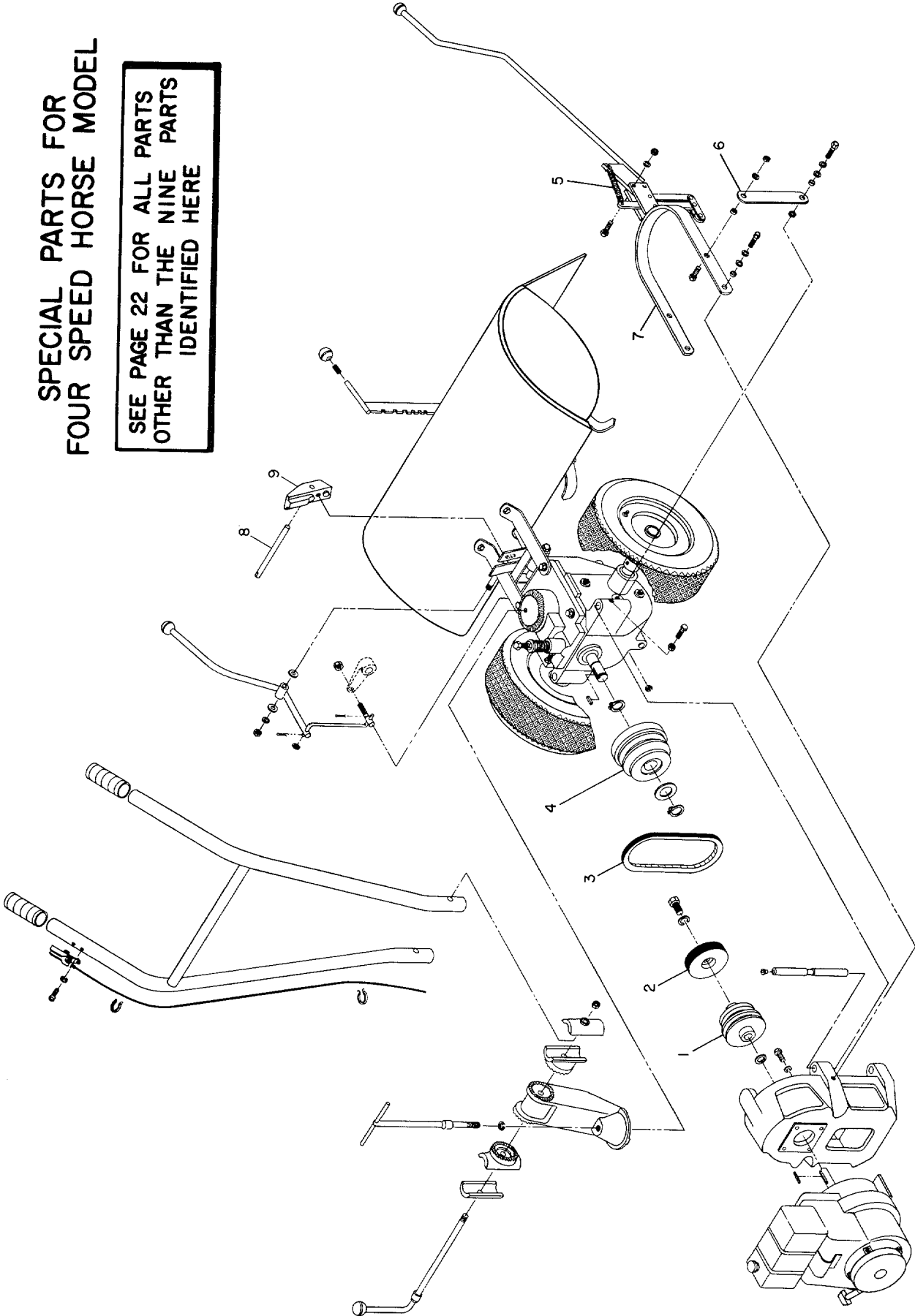

INDEX NO.	PART NO.	DESCRIPTION	NO. REQ'D	REPLACES
SPECIAL PARTS FOR FOUR-SPEED HORSE MODEL (Tiller Serial No. 314151 and Up)				
1	1483	PULLEY—engine PTO/driven, uses single belt, tiller serial No. 314151 & Up	1	1007-1
2	1919	REVERSE DISC—rubber rimmed, use only with Part #1484 transmission drive pulley (with flat surface for disc). For four-speed tiller only. Includes new-style Part #1920 adjustment block, see Index #9. Use only with #1920 block. If disc mounting bolt or lockwasher is needed, see Index #'s 16, 17 or 17A on Page 23.	1	1485, 1072
3	9245	BELT—single "V" belt, made specially for your tiller (no substitute recommended due to extra strength required)	1	1128 pair
4	1484	PULLEY—transmission drive, cast iron, uses single belt and rubber rimmed reverse disc, tiller serial No. 314151 & Up	1	1008-1
5	1492	SPRING—clutch pawl, for four-speed tiller only, tiller serial No. 314151 & Up	1	1122
6	1488	LINK—yoke pivot (clutch control), 6 $\frac{7}{8}$ ", use on four-speed tiller only....	1	1098
7	1921	CLUTCH CONTROL YOKE—for four-speed tiller only. Includes new-style Part #1920 adjustment block (Index #9). NOTE: Earlier-style Part #1487 yoke (with shifting tab) can be used with Part #1920 adjustment block, but tab must be removed—see removal instructions (Literature code SER-106)	1	1487
8	2100	ROD—belt adjustment, 7" long, with measuring gauge. For use with Part #1920 (Index #9) adjustment block	1
9	1920	BLOCK—belt adjustment, 3 $\frac{7}{8}$ " long, for four-speed tillers. Includes mounting hardware (see Index #'s 9, 10 & 11 on Page 15) and adjustment rod (Index #8 above). Use with Part #1921 yoke or #1487 yoke (with tab removed)	1	1133-1A

COMMON PARTS FOR
TWO SPEED & FOUR SPEED
HORSE MODEL

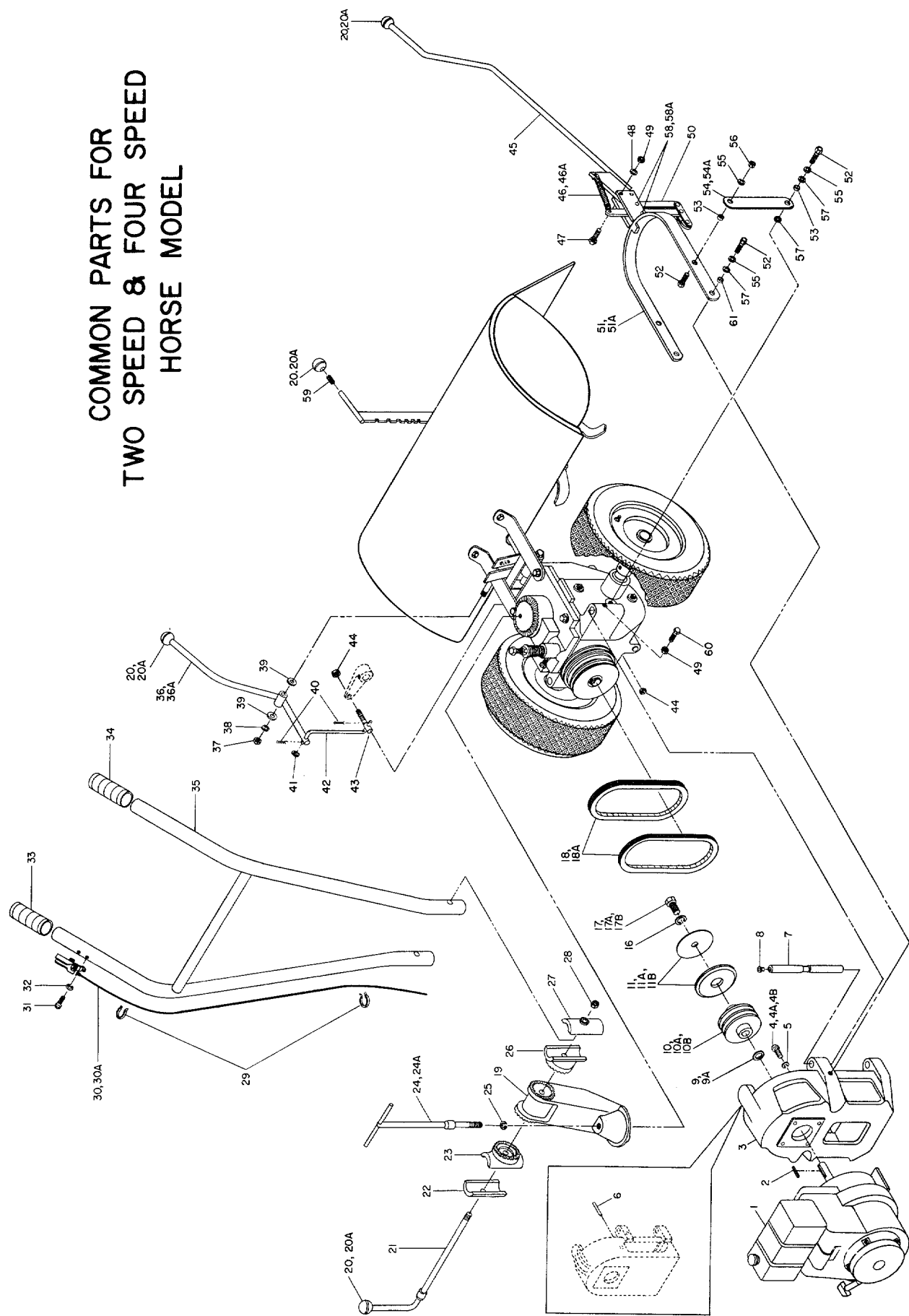

INDEX NO.	PART NO.	DESCRIPTION	NO. REQ'D	REPLACES
ENGINE & MOUNT, PULLEY, BELTS, HANDLEBARS & SHIFT LEVERS				
1	ENGINE—see Page 26 for engine listing	1
2	9303	KEY—3/16" square x 2½" engine pulley	1
3	1698	MOUNT—engine to tiller, with cast-in belt guides instead of roll pins	1	1002
4	9707	BOLT—5/16"-24 x 1", engine mtg. for Tecumseh & Briggs and Stratton engines	4
4A	9704	BOLT—hex. head, 5/16"-18 x 1", Clinton engine (mounting)	4
4B	9732	BOLT—5/16"-24 x 7/8", engine mounting to 7 H.P. Kohler mounting plate for tiller serial numbers 252356 & below	4
5	9912	LOCKWASHER—5/16"	4
6	9310	PIN—roll (spiral) ¼" x 2½" belt guide pins, used as belt guides with earlier style motor mount (also see Index 20, Page 41)	2	1099
7	1034	BAR—engine mounting	2
8	9147	PLUG—thread protection, red plastic	2	9121, 1216
9	1138-1	SHIM—engine pulley, 1/16" thick, Tecumseh (2-5), Kohler (2, 5-7), Clinton (1)	as req'd
"	1138-2	SHIM—engine pulley, 1/32" thick, Tecumseh (1), Kohler (1), Briggs and Stratton (3), Clinton (2)	as req'd
9A	1213	SHIM—engine pulley, Clinton Engine, hardened, 1/16" thick, (1) closest to engine	as req'd
10	1483	PULLEY—engine PTO driven, uses single belt, for four-speed tillers, Tiller Serial #314151 & Up, see Index 4, Page 21	1	1007-1
10A	1007-1	PULLEY—engine PTO driven, uses pair of belts, tiller serial No.'s 2731 to 314150; between tiller serial No.'s 2731 and 5983 pulleys were aluminum and from No.'s 5984 & Up pulleys are cast iron	1	1007A
10B	1007	PULLEY—engine PTO driven, uses single belt tiller serial No. 2730 & below, 4½ H.P. engine maximum	1
11	1919	DISC—reverse, rubber rimmed, for four-speed tillers, see Index 2, Page 21. Includes Part #1920 adjustment block	1	1485
11A	1072A	DISC—reverse, hard fiber, with #1287 mtg. plate, for two-speed tillers, Serial No's. 163830 to 314150	1
11B	1072K	DISC—reverse, hard fiber, with #1287 mtg. plate & #1291 washer, for two-speed tillers, Serial No's. 163829 & below	1
16	9913	LOCKWASHER—¾"	1
17	9738	BOLT—hex hd., ¾"-24 x 1¾", engine pulley mtg., Tecumseh engine	1	1075, 9715
17A	9715	BOLT—hex hd., ¾"-24 x 1½", engine pulley mtg., Kohler & Briggs and Stratton engines	1
17B	9708	BOLT—hex head, 5/16"-24 x 1½", eng. pulley mounting, Clinton engine	1
18	9245	BELT—single "V" for four-speed tillers, see Index 3, Page 21	1
18A	1128	BELTS—"V", pair, tiller serial No.'s 2731 to 314150, two speed tillers. Earlier tillers used a single #1128 belt & #1007 pulley	1 pair
19	1019	BASE—handlebar, left-to-right adjustment	1	1261
20	9119	KNOB—wheel speed lever, forward/reverse lever, depth regulator, handlebar height adjustment, includes retaining ring, part #9120. Used on tiller serial No. 19331 & up	4	9136, 1118
20A	9136	KNOB—SAME AS ABOVE except threaded, ½"-13 thread, used on tiller serial No. 19330 & below	4	1118
21	1881	STUD—handlebar height adjustment, includes #9119 knob and #9803 nut	1
22	1021-2	CLAMP—handlebar adjustment, right	1
23	1020-2	RATCHET—handlebar adjustment, right	1
24	1043	CLAMP—"T" bar, handlebar mounting, 10½"	1
24A	1167	CLAMP—"T" bar, handlebar mounting, electric start, 14¼"	1
25	9915	LOCKWASHER—5/8"	1
26	1020-1	RATCHET—handlebar adjustment, left	1
27	1021-1	CLAMP—handlebar adjustment, left	1
28	9803	NUT—hex., ½"-13	1	9805

COMMON PARTS FOR TWO SPEED & FOUR SPEED HORSE MODEL

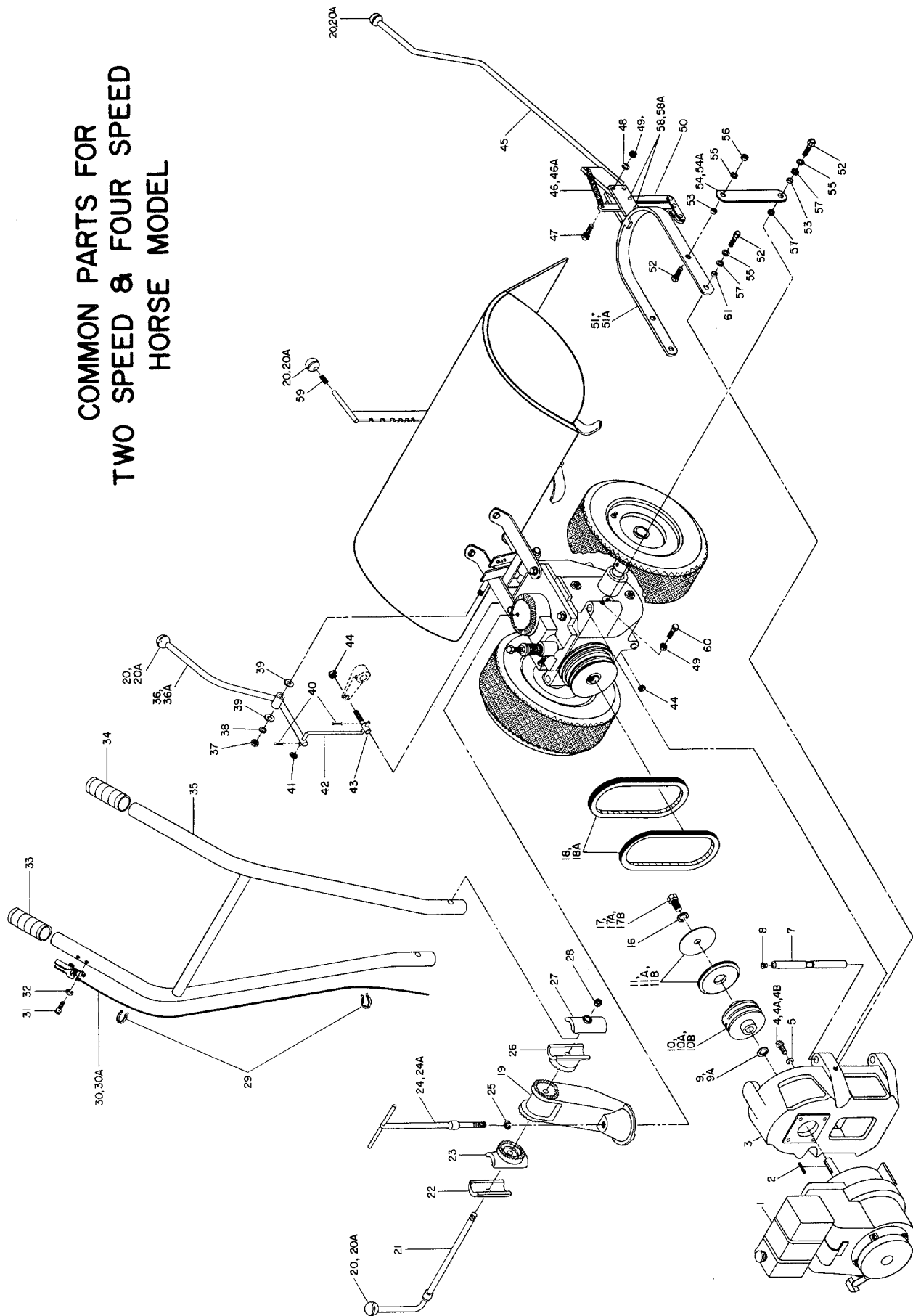

INDEX NO.	PART NO.	DESCRIPTION	NO. REQ'D	REPLACES
ENGINE & MOUNT, PULLEY, BELTS, HANDLEBARS & SHIFT LEVERS (continued)				
29	9116	CLIP—throttle cable retaining	1	1218
30	9240	CABLE—throttle, complete. For 6 HP Tecumseh (manual choke only), 7 HP Kohler, 4½ HP Clinton and 8 HP Briggs & Stratton engines. Also order #9733 screws & #9909 lockwashers, if needed.	1	1195, 9115
30A	9115	CABLE—throttle, complete. Use with 6 HP Tecumseh (automatic choke only) engines. Also order #9733 screws & #9909 lockwashers, if required.	1	1195
31	9733	SCREW—pan head, self-tapping	2
32	9909	LOCKWASHER—#10	2
33	9118	GRIP—rubber, handlebar, see Index 34 for electric start grip	2	1095
34	9141	GRIP—rubber, handlebar left side (for push-button electric start only). Use one instead of #9118. Includes starter button spacer #1180	1	9118
35	1046A	HANDLEBARS—includes two grips, specify standard or electric	1	1046
36	1843	LEVER—wheel shift, for single pin eccentric transmissions, Tiller Serial #493014 & Up. Includes #9119 knob and #9120 retaining ring.	1	1230A
36A	1230A	LEVER—wheel shift, for fork shoe transmissions, Tiller Serial #19741 to 493013. Includes #9119 knob and #9120 retaining ring. See Note 1 below	1	1030, 1230
37	9806	LOCKNUT—hex., ½"—20, self-locking	1	9804
38	9914	LOCKWASHER—½"	1
39	9907	WASHER—plain, ½" S.A.E. (inside washer optional)	2
40	9317	PIN—cotter, 3/32" x 1"	2
41	9902	WASHER—plain, 5/16" S.A.E., O.D. 11/16"	1
42	1231	ROD—connecting rod, speed shift lever	1
43	1033	SWIVEL—connecting rod	1
44	9808	LOCKNUT—hex. head, 5/16"-18	1
45	1134A	LEVER—forward/neutral/reverse, includes #9119 knob, Index #20	1	1134
46	1492	SPRING—clutch pawl, for four-speed tillers only, see Index 5, page 20	1
46A	1122	SPRING—clutch pawl for two-speed tiller	1
47	9705	SCREW—hex. head, 5/16"-18 x 1¼", lever to yoke	2	1211
48	9912	LOCKWASHER—5/16"	2
49	9801	NUT—hex. head, 5/16"-18	4
50	1042	ROLLER ASSEMBLY—clutch, Forward/Reverse	1
....	1051A	REPAIR KIT—roller assembly, includes #1051 roller, #9346 clevis pin and #9317 cotter pin	1
51	1921	YOKE—clutch control, no shifting tab on yoke, for four-speed tillers only, see Index 7, Page 21	1	1487
51A	1037	YOKE—clutch control, for two-speed tillers, Serial #314150 & Below.	1
52	9710	BOLT—hex. head, ¾"-16 x 1", yoke linkage	6
53	1113-1	BUSHING—spacer, 9/16" long, yoke linkage	4
54	1488	LINK—yoke pivot (clutch control), 6⅞" long, four-speed only, see Index 6, Page 20	2
54A	1098	LINK—yoke pivot (clutch control), 6⅞" long, two-speed tillers only	2
55	9913	LOCKWASHER—¾"	6
56	9802	NUT—hex., ¾"-16	2
57	9904	WASHER—plain, ¾" S.A.E., O.D. 13/16"	6
58	9323	ROLL PIN (spiral), 5/16" x 1"	2
58A	1136	RIVET—5/16" x 1¼", #36 drilled hole, clutch roller assembly prior to Tiller Serial No. 31208 rivets were used instead of roll pins	2
59	9120	RING—retaining (tolerance ring)	4
60	9704	BOLT—hex. head, 5/16"-18 x 1"	2
61	2146	BUSHING—spacer, 11/16" long, yoke to engine mount	2	1113-1

NOTE 1—For tiller serial No's. 19740 & below order #1230 wheel speed shift lever. It will include #9317 (2), #9902, #9808 & #1231 at cost of current price of #1230 lever. Please indicate that it is a replacement for part #1030 and it is for a tiller serial number below NO. 19741.

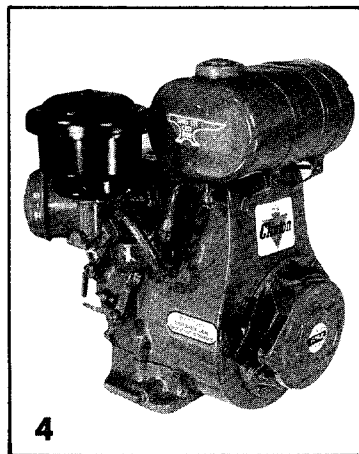
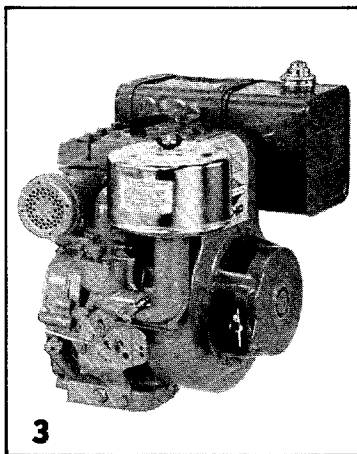
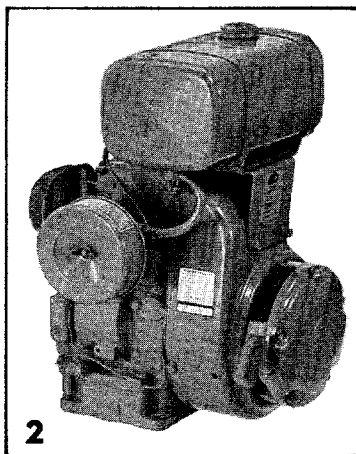
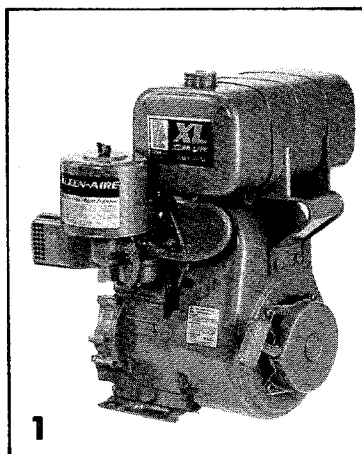

Here's How To Find Your Engine Model Numbers

TECUMSEH-LAUSON 6 H.P. ENGINE

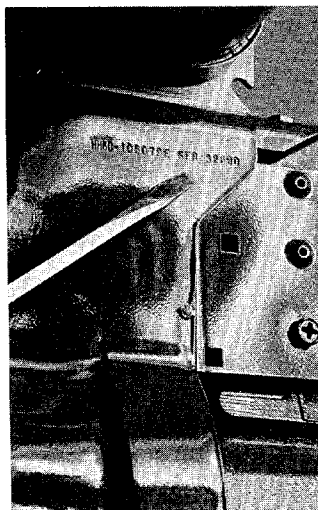

LOOK HERE . . . On the side of the engine blower housing opposite the starter rope.

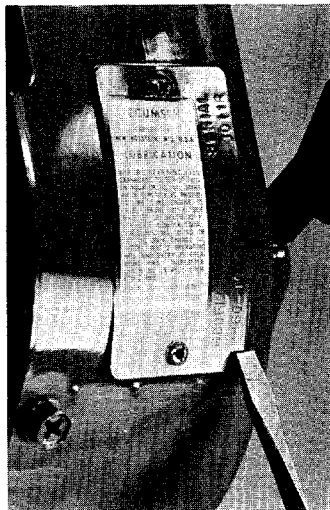

OR, LOOK HERE . . . Next to the lubrication instructions.

CLINTON 4 1/2 H.P. ENGINE



LOOK HERE . . . Screwdriver points to model and spec. nos. stamped (edge-wise) in red metal.

KOHLER 7 H.P. ENGINE

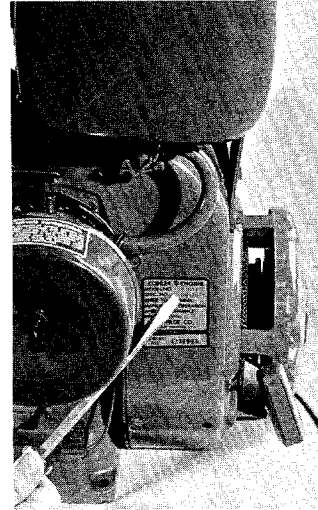

LOOK HERE . . . Model and spec. nos. on Kohler name plate.

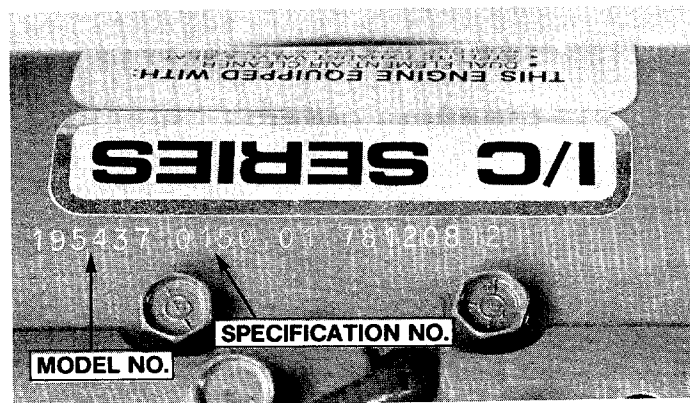

BRIGGS AND STRATTON 8 H.P. ENGINE

LOOK HERE . . . on top of the blower housing between the chrome air cleaner and the chrome fuel cap.

INDEX PART NO. NO.	DESCRIPTION ENGINES	NO. REQ'D REPLACES
If you are interested in a replacement engine for your tiller, please call or write our Customer Service Department here at the factory. Your Owner Service Representative will then be able to advise you as to which engines are compatible with your tiller, and will provide you with a current price list and necessary ordering information. Thank you.		
1 1870	ENGINE—6 HP Tecumseh, Model #HH-60, Specification #105115H, standard recoil starting , manual choke, dual element air cleaner, 1" crankshaft is turned down at power takeoff end to ¾" to accept engine pulley. Engines have a cast iron cylinder block & crankcase. See Notes 1 & 2 below	1
1A 1868	ENGINE—6 HP Tecumseh, Model #HH-60, Specification #105116H, electric starting , manual choke, same as above but with electric start and automatic battery recharging system. For use with tillers already equipped with Key Switch Starting System (see Pages 28-29). The earlier, Push Button Starting System (see Pages 30-31) is not compatible with this engine. Also see Notes 1 & 2 below	1
1B 1869	ENGINE—6 HP Tecumseh, electric starting . Same as Part No. 1868 above, but comes with parts necessary to convert from Push Button Starting System to Key Switch Starting System. We are no longer able to stock an engine that is compatible with the Push Button System. See Note 1 below	1
2 1927	ENGINE—7 HP Kohler, "Professional," Model #K161T, Specification #281293. Standard recoil starting (electric start not available). Has remote throttle lever engine shutoff switch, introduced on Tiller Serial #599200 (see Note 3). Engine is cast iron, industrially rated, with bearings at both ends of crankshaft. Compression release. 1" crankshaft is turned down at power take off end to ¾" to accept engine pulley. Must use special time hood operating decal (Part #2156) which is supplied with replacement engines ordered from Garden Way	1
3 1838	ENGINE—8 HP Briggs & Stratton, "Professional," Model #195432, Type #0149-01, standard recoil starting . Manual choke, 1" crankshaft is turned down at power takeoff end to ¾" to accept engine pulley. Engine has high silicon-copper aluminum alloy cylinder block with permanent cast iron cylinder sleeve, industrially rated, with bearings at both ends of crankshaft. ONLY TILLERS HAVING TILLER SERIAL NO'S. 384172 & UP, MADE AFTER MARCH 6, 1979, CAN SAFELY USE 8 HP ENGINES	1
3A 1839	ENGINE—8 HP Briggs & Stratton, "Professional," Model #195437, Type #0150-01, electric starting , manual choke, same as above but with electric start and automatic battery recharging system. ONLY TILLERS HAVING TILLER SERIAL NO'S. 384172 & UP MADE AFTER MARCH 6, 1979, CAN SAFELY USE 8 HP ENGINES	1
4	ENGINE—4½ HP Clinton, Model #498-0301-280, standard recoil starting , 1" crankshaft is turned down at power takeoff end to ¾" to accept engine pulley. Cast iron block. No longer available from Garden Way. Can replace with Part No's. 1870 or 1927 (call Service Dept.)	1

ABOUT PROPANE ENGINES—Garden Way does not supply propane fueled engines. See your local Engine Service Dealers.

NOTE 1—All 6 HP Tecumseh engines are available with Manual Choke only. All 6 HP Electric Start engines are available with Key Switch Starting only. The automatic choke series and the Push Button Start system have been discontinued.

NOTE 2—Earlier Model Numbers of Tecumseh Engines supplied with Troy-Bilt Tillers are listed below. In most cases, number changes reflect design improvements by the engine manufacturer. Please note that some early tillers had aluminum engines at that time preferred by customers due to lower cost; these are listed separately.

NOTE 3—7 HP Kohler engines used on Tiller Serial #599199 & Below (Engine Model #K161T, Specification No's. 281291, 281287J, 281271J, 281148J, 281181) have an engine mounted Stop Button to shut off engine. This model engine no longer available from Garden Way, use Part #1927.

CAST IRON BLOCK ENGINES, USED FROM 1971 TO 1981

RECOIL START (Standard), or **ROPE PULL WITHOUT RECOIL**: HH 60 105041 C; 105049 C or D; 105061 D; 105079 D or E; 105090 E; 105101 F; 105106 F; 105106 G; 105113 G; 105113 H.

ELECTRIC START (12 Volt Battery & Starter Motor): HH 60 105049 E.S.; 105049 C, or E.S.; 105054, or C or D; 105080 D or E; 105091 E; 105102; 105103 F; 105107 F; 105107 G; 105114 G; 105114 H.

ALUMINUM BLOCK ENGINES, USED PRIOR TO 1968-69

RECOIL START (Standard), or **ROPE PULL WITHOUT RECOIL**: H 60 75173 D, E, G or L; 75251, or G or H; 75258 G.

ELECTRIC START (12 Volt Battery & Starter Motor): H 60 75165 E, F or G; 75173 L; 75250 E.S.; 75250 G; 75251 E.S.; 75259 G; 75273 G or H.

6 H.P. TECUMSEH ENGINE ELECTRIC START DIAGRAM (USED ON ELECTRIC START TILLERS WITH TILLER SERIAL NO. 291333 AND ABOVE)

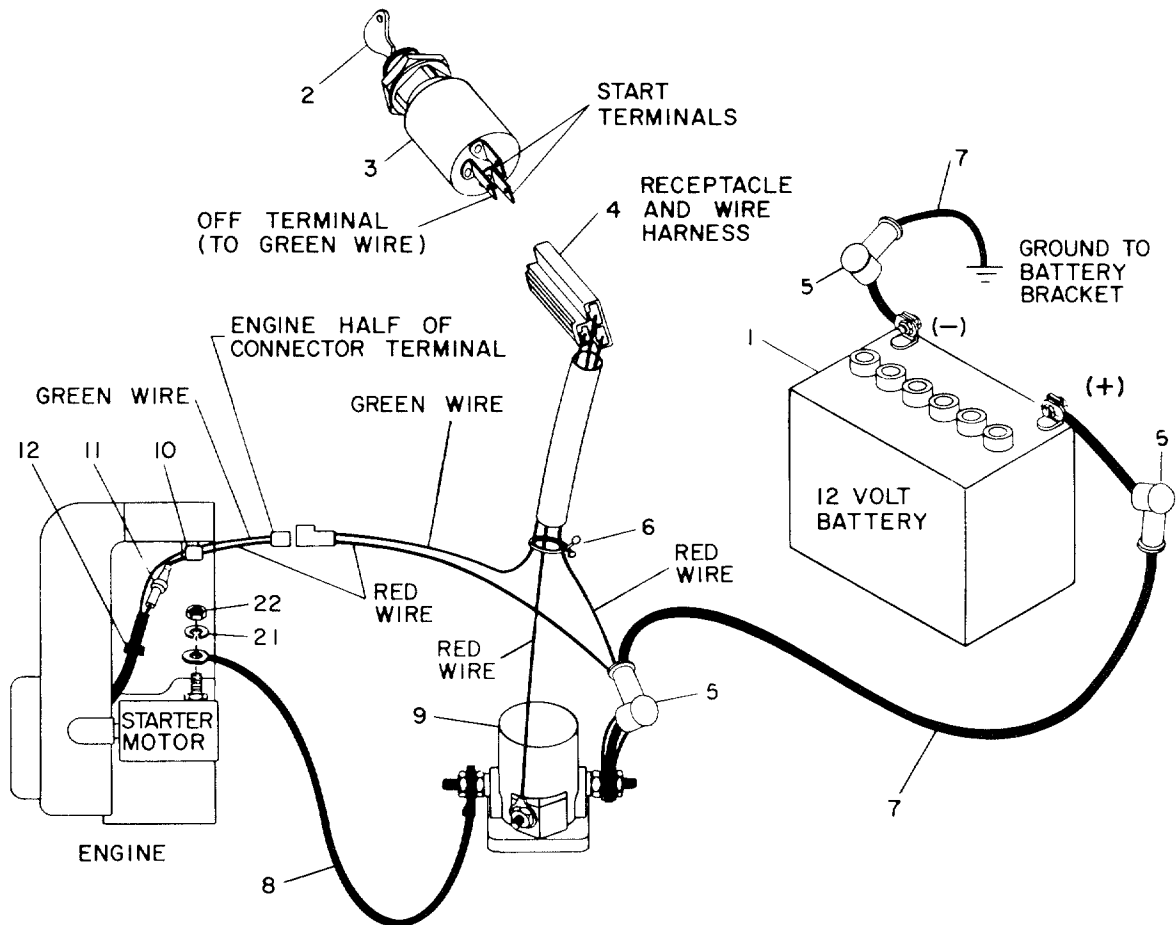

BATTERY MOUNTING BRACKET

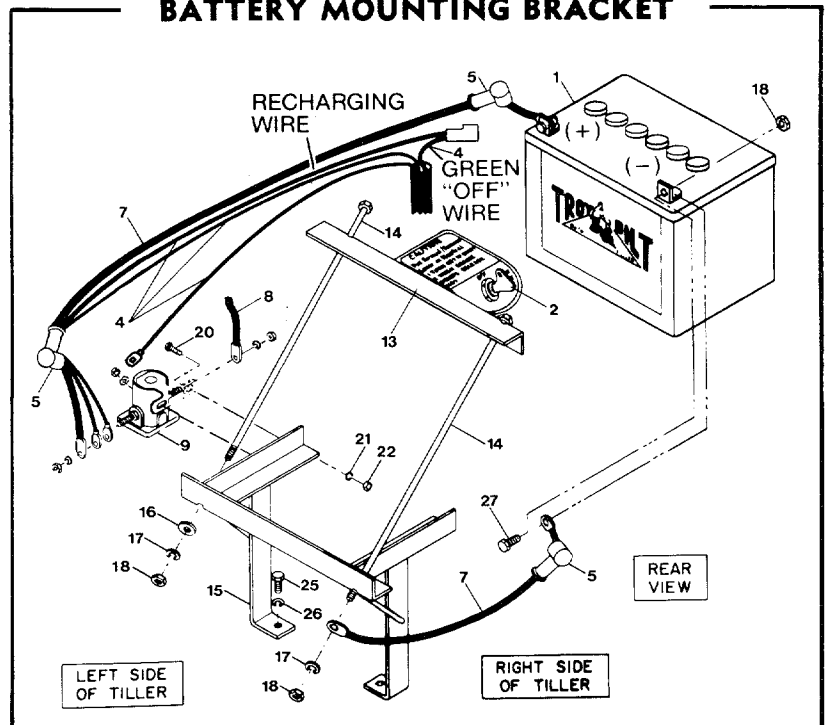

SOLENOID DETAIL

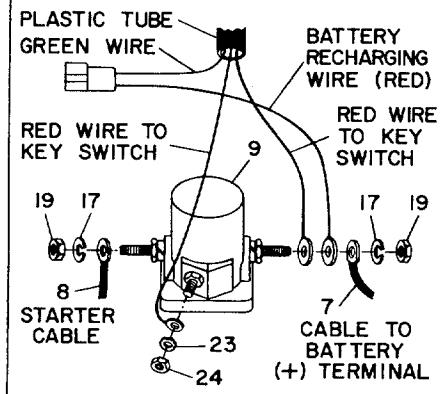

INDEX NO.	PART NO.	DESCRIPTION	NO. REQ'D	REPLACES
6 H.P. TECUMSEH KEY SWITCH ELECTRIC START SYSTEM				
1	9123	BATTERY—12 volt	1
2	9243	KEY—ignition	1
3	9230	KEY SWITCH	1
4	1552	RECEPTACLES, WIRE HARNESS & BATTERY RECHARGING WIRE, includes two receptacles, three red wires (with terminals), one green wire, plastic harness tube	1	1477, 1469
5	9255	BOOT—insulating, for battery and solenoid terminals	3
6	9265	TIE—twist, plastic	1	9202
7	9295	CABLE—battery, positive & negative cables	2	9124
8	9223	CABLE—solenoid to starter motor, small terminal at starter	1
9	9127	SOLENOID—electric start, includes nuts & washers for cables and wires	1
10	9218	CLIP—metal, supports battery recharging line	1
11	FUSE—6 amperes, 3 AGC (included with electric start 6 HP engine). Available locally or from Garden Way, Tec. #29561	1
12	DIODE—battery recharging (included with electric start 6 HP engine). For serviceman's replacement use Tecumseh Part No. 610935	1
13	1468	BATTERY HOLD-DOWN CLAMP & KEY SWITCH PLATE	1
14	9706	CARRIAGE BOLT—battery clamp, hex. head, 5/16"-18 x 9"	2
15	1169	BRACKET—battery mounting (welded)	1
16	9902	WASHER—plain, 5/16" S.A.E.	1	9901
17	9912	LOCKWASHER—5/16"	4
18	9801	NUT—hex., 5/16"-18	4
19	9826	NUT—hex., 5/16"-24	2
20	9723	SCREW—round head, 1/4"-20 x 3/4", solenoid mounting	2
21	9910	LOCKWASHER—1/4"	3
22	9800	NUT—hex., 1/4"-20	3
23	9921	LOCKWASHER—#10, center post on solenoid	1
24	9809	NUT—hex., 10-32, center post on solenoid	1
25	9713	BOLT—hex head, 3/8"-16 x 1 1/2", bracket to transmission cover (see Page 4, Index No. 66)	2
26	9913	LOCKWASHER—3/8" (see Page 4, Index No. 67)	2
27	9703	BOLT—hex head, 5/16"-18 x 3/4", cable to battery post	2
....	20418	DECAL—for key switch plate (Index No. 13)	1

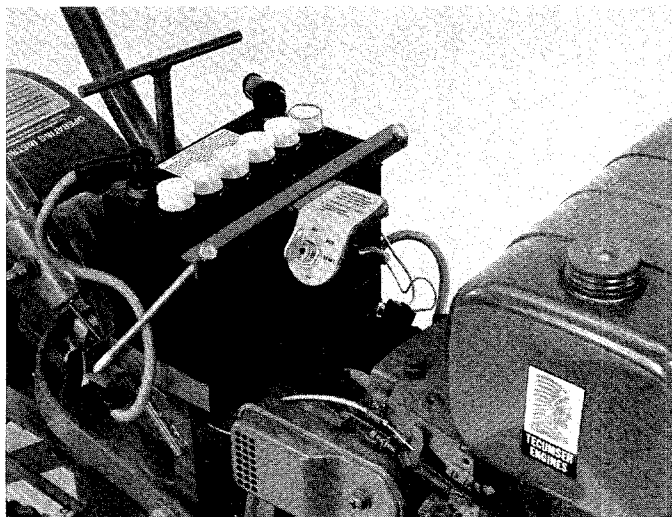

KEY SWITCH ELECTRIC START SYSTEM—Used on all electric start tillers with Tiller Serial No. 291333 and above. For earlier style, push-button system, see Pages 32 & 33.

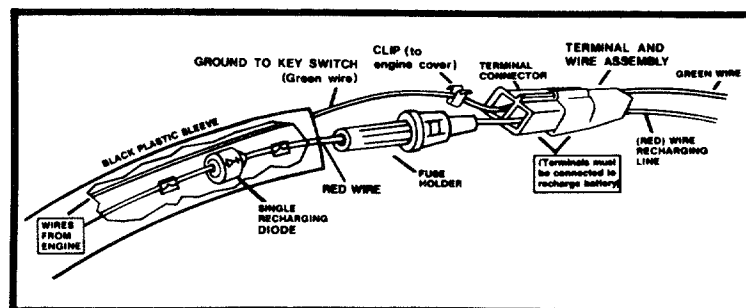

KEY SWITCH/SINGLE DIODE RECHARGING SYSTEM—To recharge battery, a small current from engine flows through diode and fuse, to the solenoid terminal and positive cable of the battery.