

Read and understand all instruction, warning, and danger labels.
Lea el manual de operación anexo sobre ensamblaje e inicio.

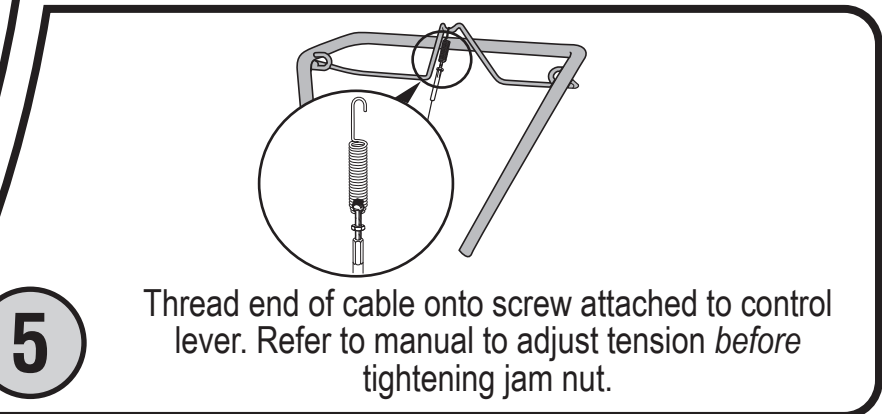
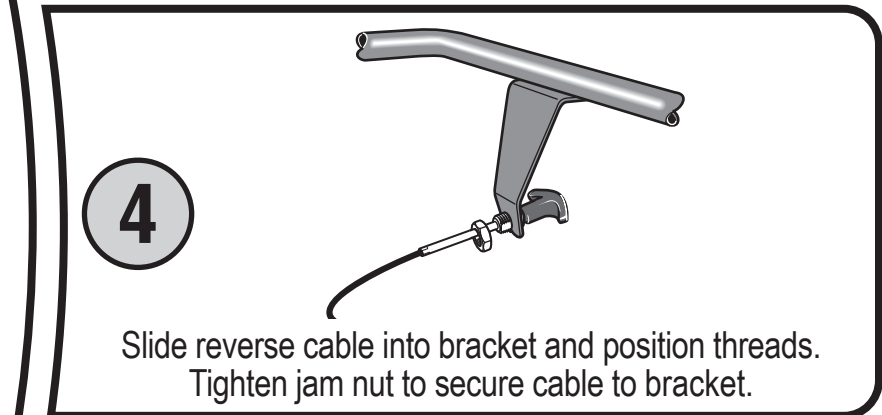
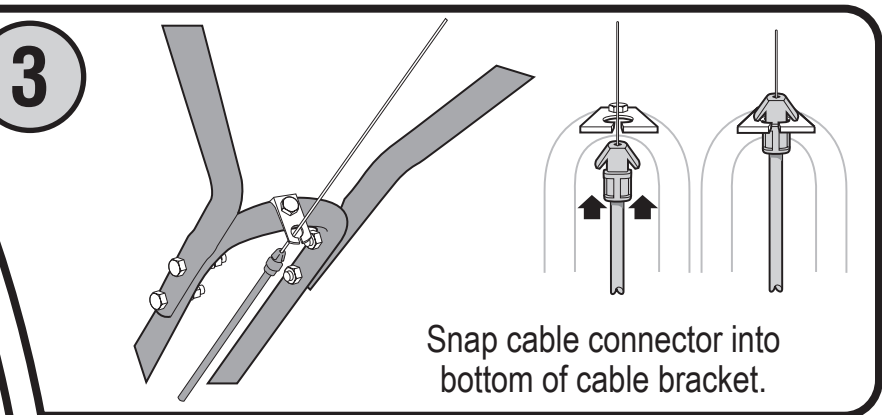
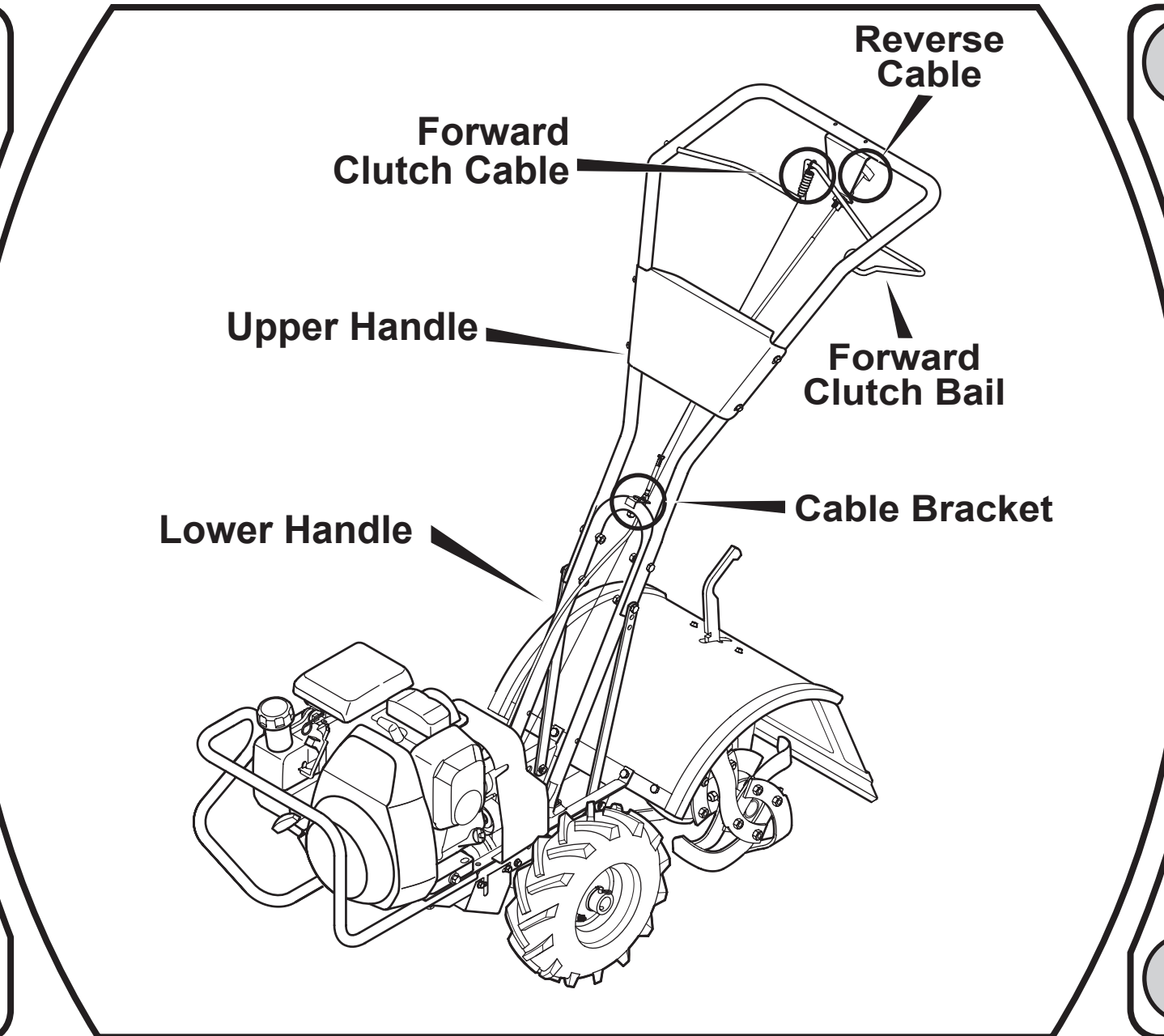
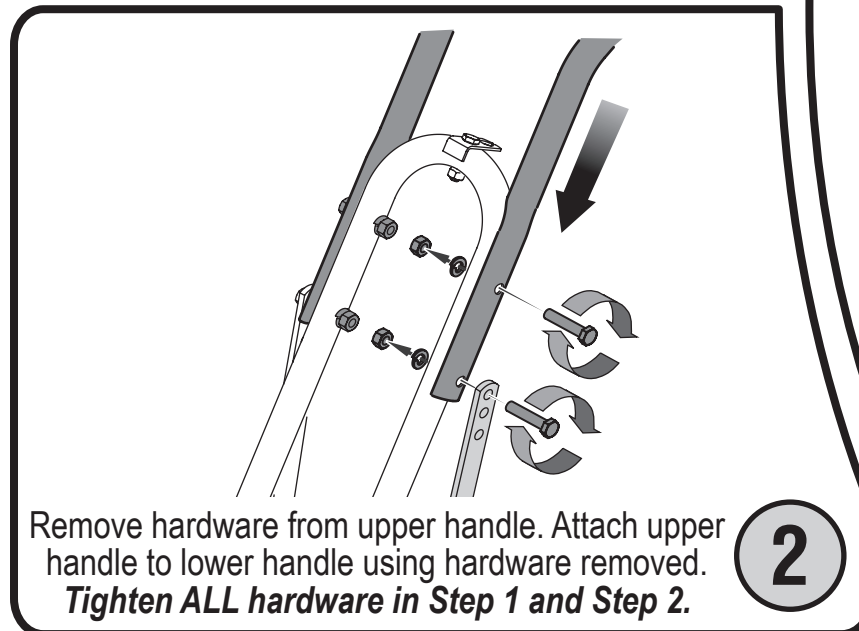
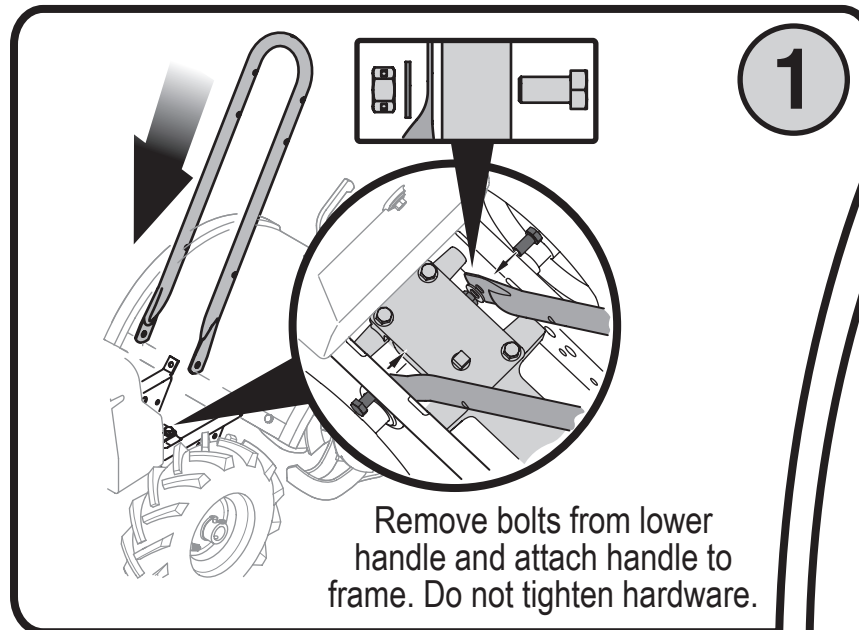

FAST START GUIDE

FAST START GUIDE

Read and understand all instruction, warning, and danger labels.
Lea el manual de operación anexo sobre ensamblaje e inicio.

6

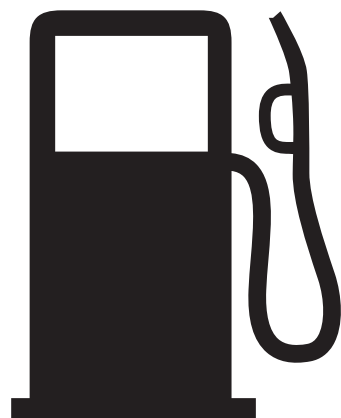

Fill tank with gas to within 1/2 inch of top of tank.

7

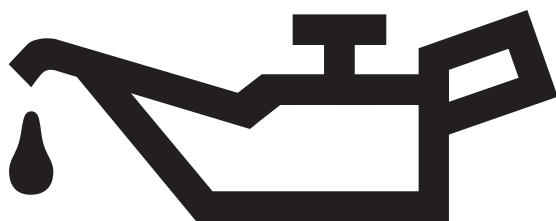

Fill engine with entire contents of oil to upper limit of dipstick. Check oil level by inserting (and not threading) dipstick into filler neck.

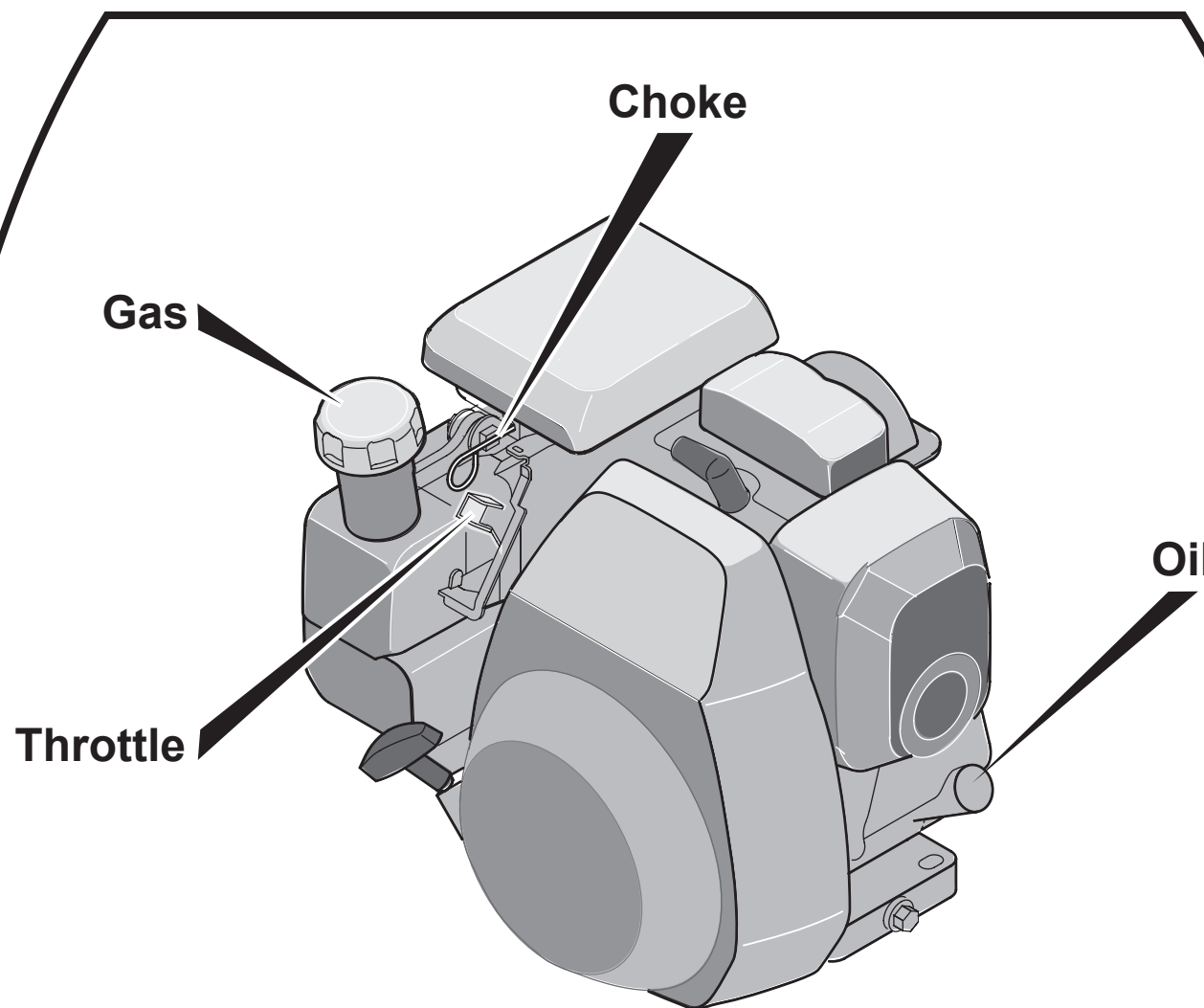

Need Help?

Call 1-888-TO-HELP-U
(1-888-864-3578)

8

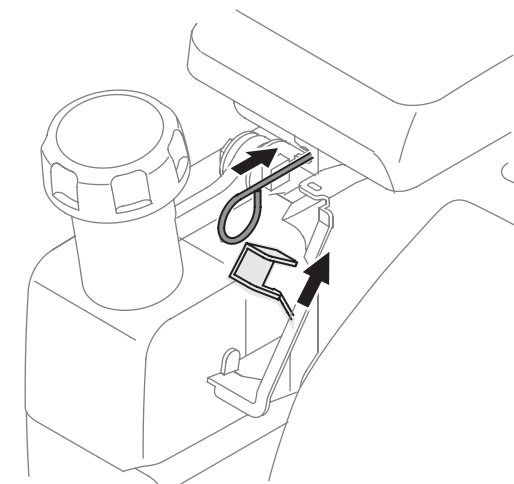

Slide choke lever to full choke position and place throttle in rabbit (fast) position.

9

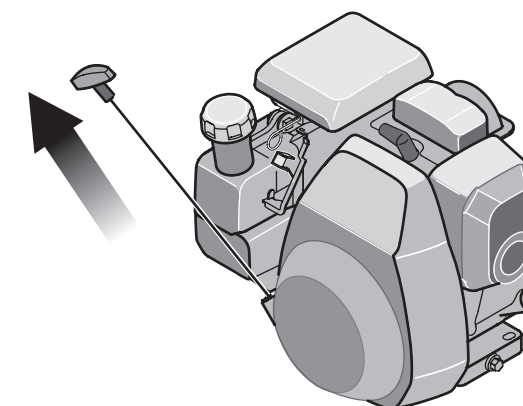

Pull starter rope with quick, full arm stroke.
(It may take more than one pull to start cold engine)
Once started, slide choke lever to off.



IMPORTANT: READ OPERATOR'S MANUAL AND ENGINE MANUAL THOROUGHLY AND FOLLOW THE SAFE OPERATION PRACTICES BEFORE OPERATING.

