



READ AND UNDERSTAND ALL INSTRUCTION, WARNING, AND DANGER LABELS.
PARA INSTRUCCIONES EN ESPAÑOL, REFIÉRASE AL MANUAL DEL OPERADOR.



FAST START GUIDE

1

Remove the wing knobs and carriage bolts from the upper portion of the lower handle.

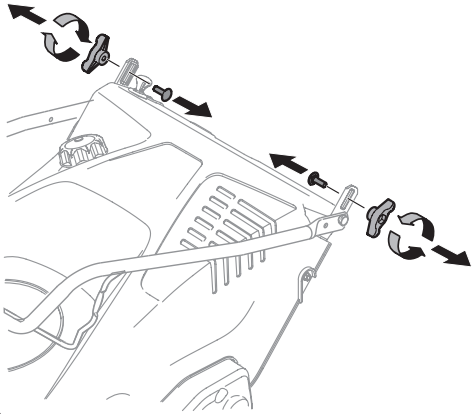

2

- A. Pivot the upper handle into the operating position.
- B. Tighten the wing knobs to secure the handle.

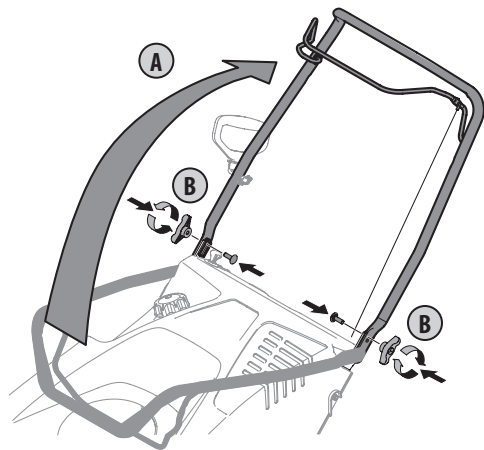

Remove the screws from the chute base.

3

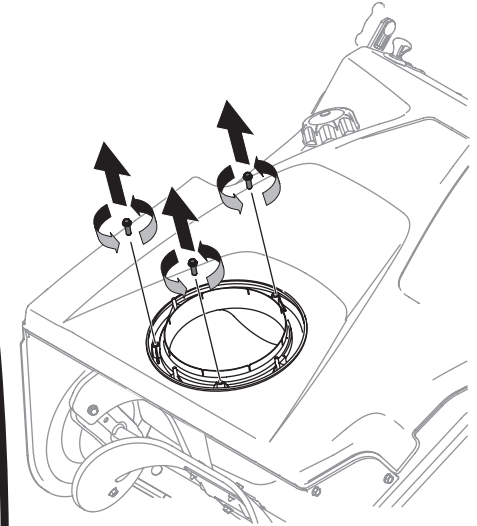

Chute Assembly

Upper Handle

Wing Knobs

Lower Handle

4

Position the chute assembly on the chute base and secure with the screws removed in Step 3.

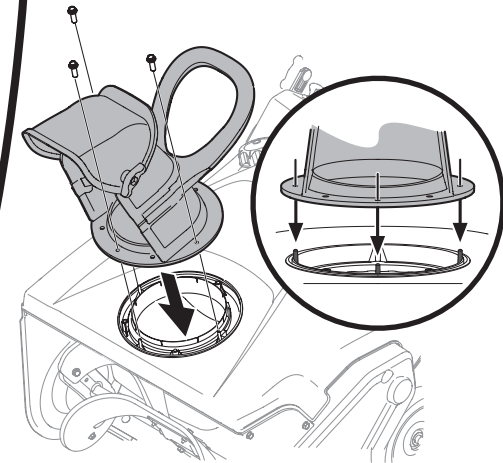

IMPORTANT: READ OPERATOR'S MANUAL AND ENGINE MANUAL THOROUGHLY AND FOLLOW THE IMPORTANT SAFE OPERATION PRACTICES BEFORE OPERATING .



Need Help? Call 1-888-TO-HELP-U



READ AND UNDERSTAND ALL INSTRUCTION, WARNING, AND DANGER LABELS.
PARA INSTRUCCIONES EN ESPAÑOL, REFIÉRASE AL MANUAL DEL OPERADOR.



FAST START GUIDE

5

Pour the entire contents of the oil bottle (included in carton) into the oil fill.



6

Fill fuel tank with clean, fresh gasoline. Do not fill above the base of fuel tank neck.

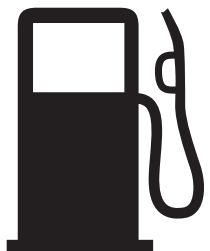

7



Insert the key into the key switch until the key snaps into place. Do *not* turn the key!

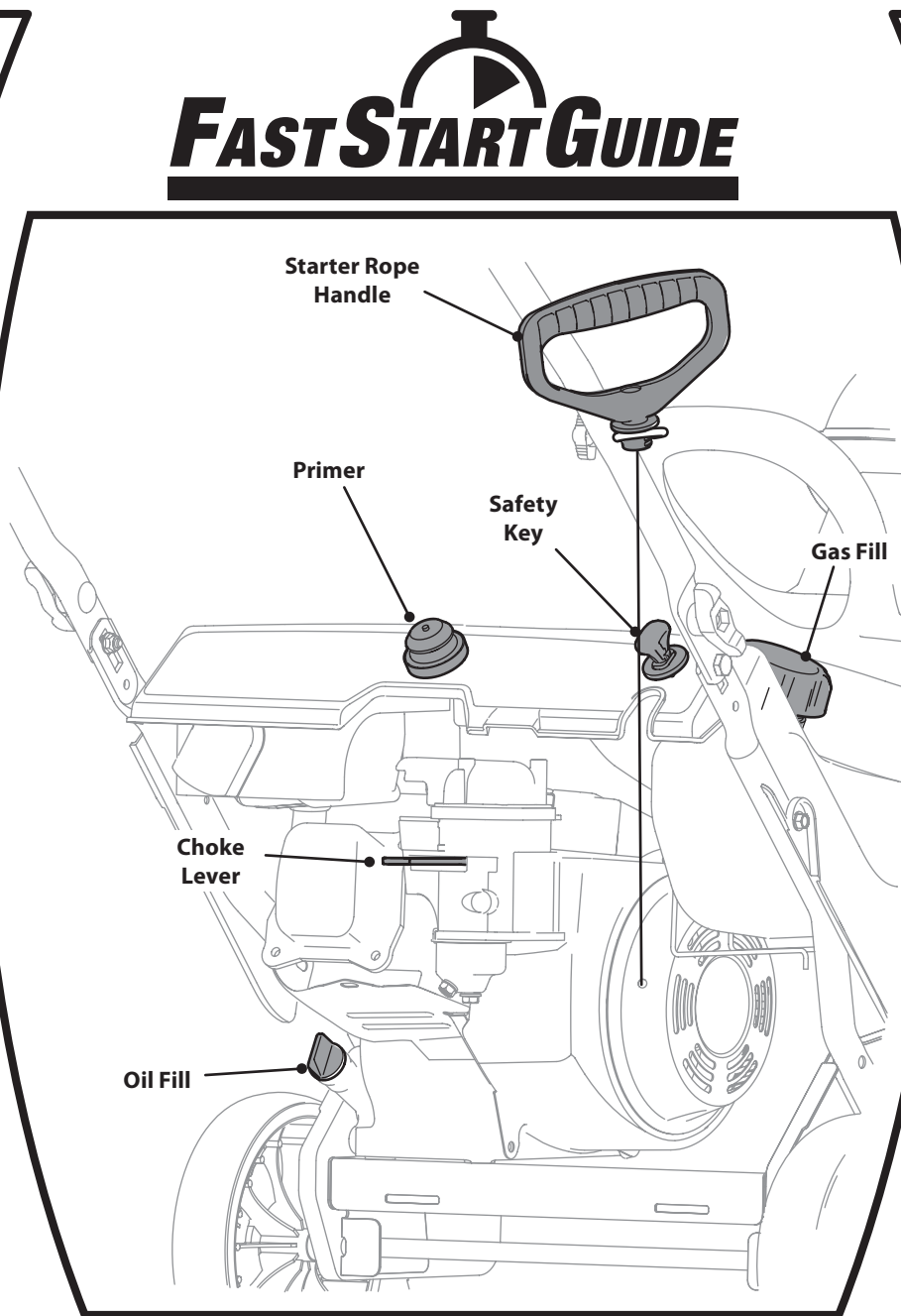

8

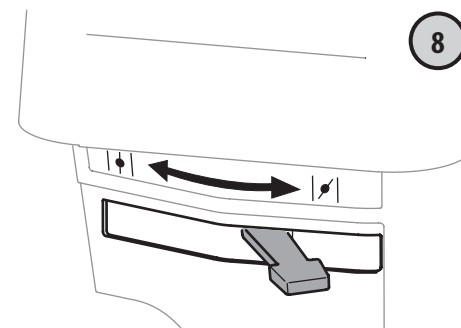

Move the choke lever into the Choke position.

9

Press the primer five- to-seven times.

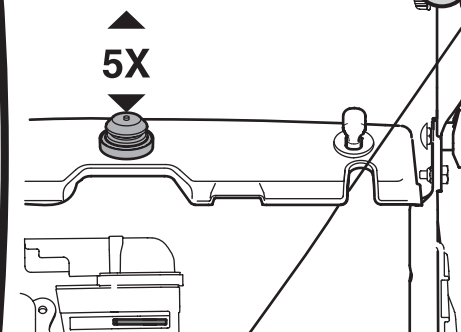

10

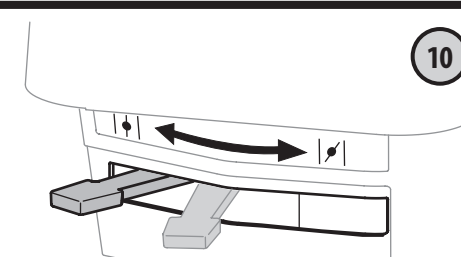

Grasp starter rope handle and pull with quick, full-arm stroke.

After starting, move the choke lever to 1/2-choke position. When the engine runs smoothly, move it into the Run position.



IMPORTANT: READ OPERATOR'S MANUAL AND ENGINE MANUAL THOROUGHLY AND FOLLOW THE IMPORTANT SAFE OPERATION PRACTICES BEFORE OPERATING .



Need Help? Call 1-888-TO-HELP-U