



READ AND UNDERSTAND ALL INSTRUCTION, WARNING, AND DANGER LABELS.  
PARA INSTRUCCIONES EN ESPAÑOL, REFIÉRESE AL MANUAL DEL OPERADOR.



1

To rest the FLEX™ Power Base after unpacking it from the shipping carton, and/or when no attachment is present, a convenient Latch'n Lock™ kickstand has been provided on the rear of the unit. Simply deploy the Latch'n Lock™ kickstand to park the FLEX™ Power Base when no attachment is present.

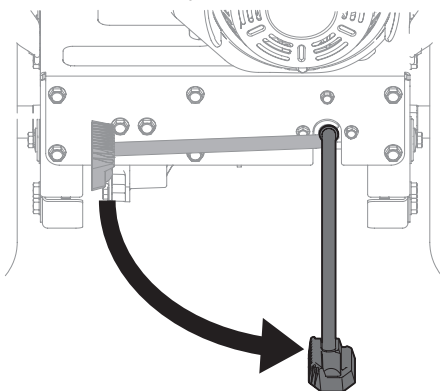

2

Remove any packaging material from the upper handle.

Loosen the handle adjustment knobs (A) and pivot the upper handle assembly upwards (B) until it reaches the optimal operating position based on the operator's preference.

**Note:** The handles can only be put into 3 positions.

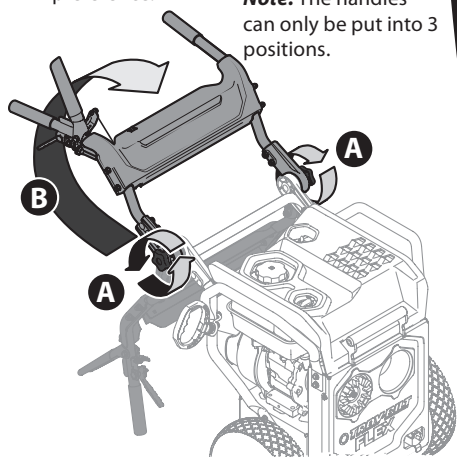

# FAST START GUIDE

Attachment  
Control Safety  
Lock

Attachment  
Control Lever

On/Off Switch

Handle Adjustment Knob

Drive Control  
Lever

Latch'n  
Lock/  
Kickstand

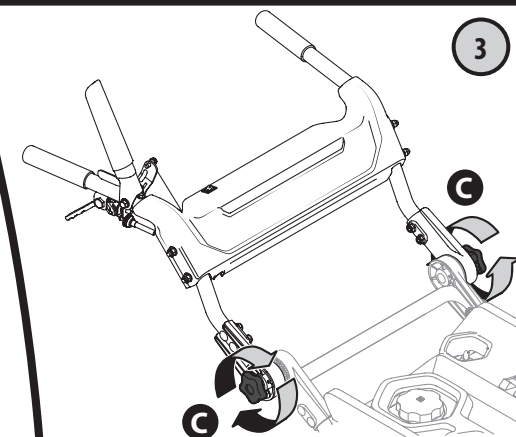

Tighten the handle adjustment knobs (C) to firmly secure the upper handle and support tubes.

**Note:** The convenient handle adjustment knobs (C) are available for the operator to simply make a handle adjustment, based on preference and/or application, quickly, and easily.

4

To put the handlebars in the stowed position loosen the handle adjustment knobs (A), and pivot the upper handle assembly downwards (B) until it reaches the bottom of its pivot motion.

Lightly tighten the two handle adjustment knobs (C) to secure the upper handle into stowed position.

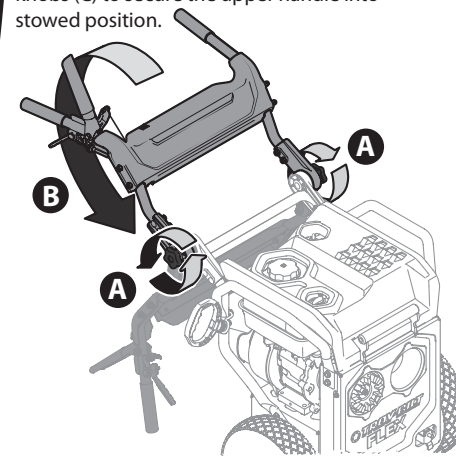

IMPORTANT: READ OPERATOR'S MANUAL AND ENGINE MANUAL THOROUGHLY  
AND FOLLOW THE IMPORTANT SAFE OPERATION PRACTICES BEFORE OPERATING .



Need Help? Call 1-888-TO-HELP-U



READ AND UNDERSTAND ALL INSTRUCTION, WARNING, AND DANGER LABELS.  
PARA INSTRUCCIONES EN ESPAÑOL, REFIÉRESE AL MANUAL DEL OPERADOR.



5



Add the oil included in manual bag to the engine. (Refer to the Operator's Manual)

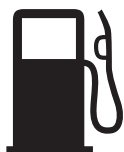

Fill fuel tank with clean, fresh gasoline. Do not fill above the base of fuel tank neck.

6

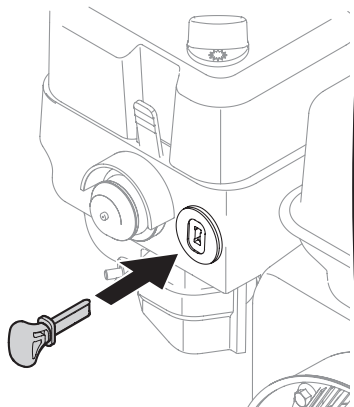

Insert the key into the key switch until the key snaps into place.  
Do *not* turn the key!

7

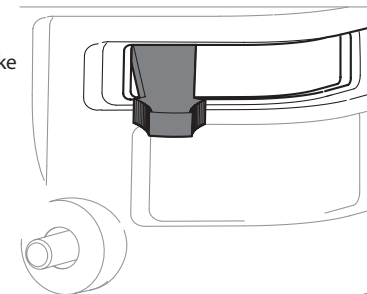

Move the choke control into the Full Choke position.

**Note:** Engine needs to be choked when the engine is cold in warm weather. It must be choked every time in cold weather. Refer to starting label.

# FAST START GUIDE

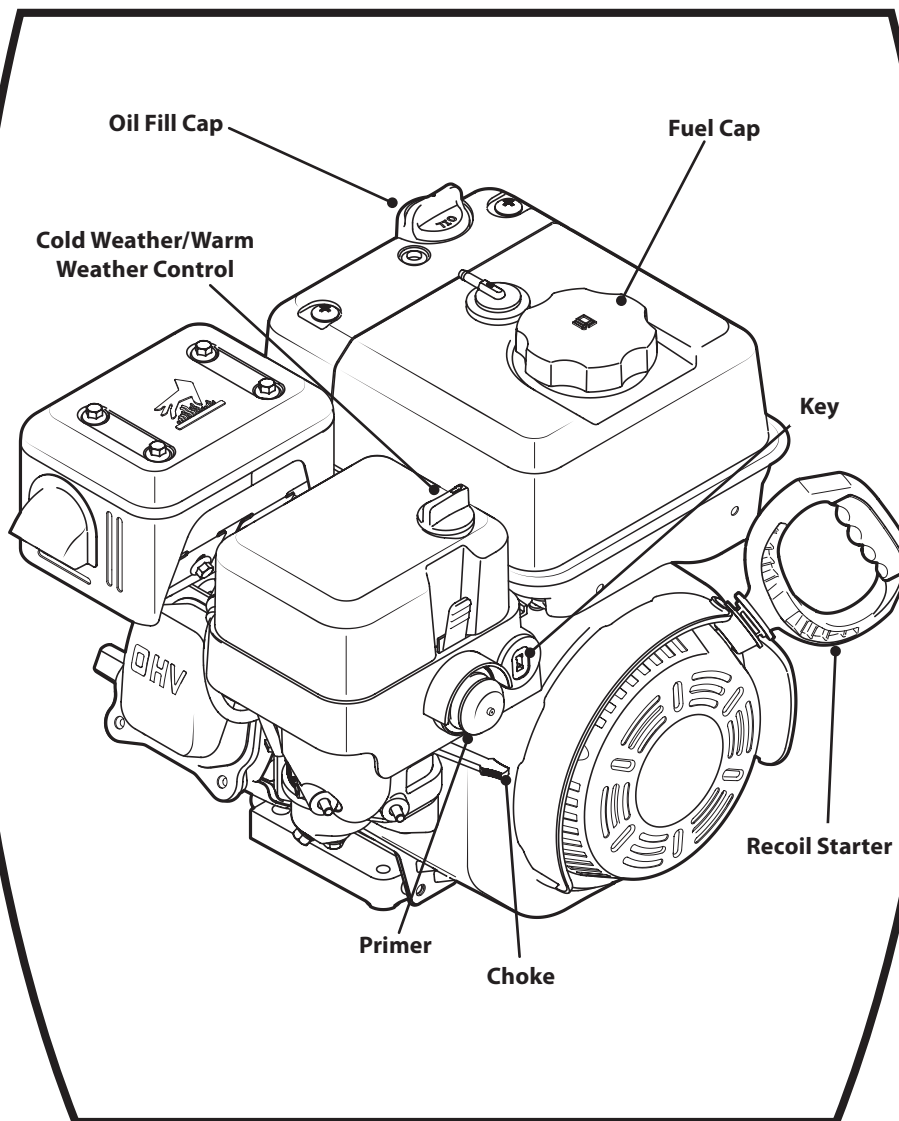

8

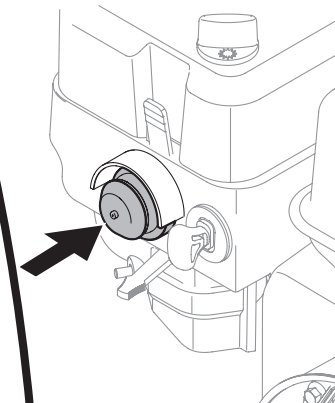

Push primer 3-5 times (Cold weather only).

Make sure you cover the vent hole with your thumb.

Hold the primer bulb in for one full second each time you press it.

9

Turn Cold Weather/Warm Weather Control knob to appropriate position.

**Note:** Cold weather is below 32°F and warm weather is above 32°F.

**Cold Weather**

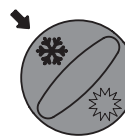

**Warm Weather**

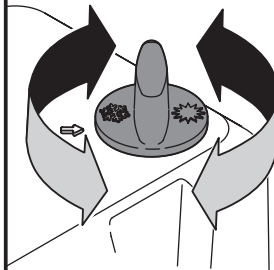
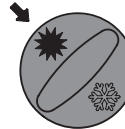

10

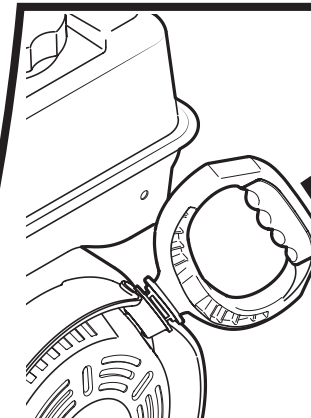

Pull starter rope with quick, full arm stroke. When engine starts, slowly move choke control into the RUN position.



IMPORTANT: READ OPERATOR'S MANUAL AND ENGINE MANUAL THOROUGHLY AND FOLLOW THE IMPORTANT SAFE OPERATION PRACTICES BEFORE OPERATING.



Need Help? Call 1-888-TO-HELP-U