



**READ AND UNDERSTAND ALL INSTRUCTION, WARNING, AND DANGER LABELS.**  
**PARA INSTRUCCIONES EN ESPAÑOL, REFIÉRESE AL MANUAL DEL OPERADOR.**



1

Attach the red cable to the positive (+) battery terminal and attach the black cable to the negative (-) battery terminal with the bolts and hex nuts.

Position the red rubber boot over the positive battery terminal.

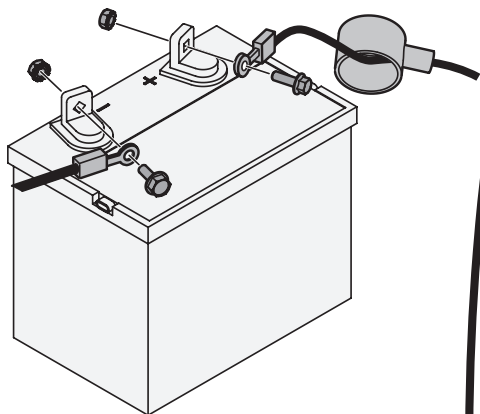

2

Remove the shipping brace from the discharge opening by grasping it between your thumb and index finger and rotating it clockwise.

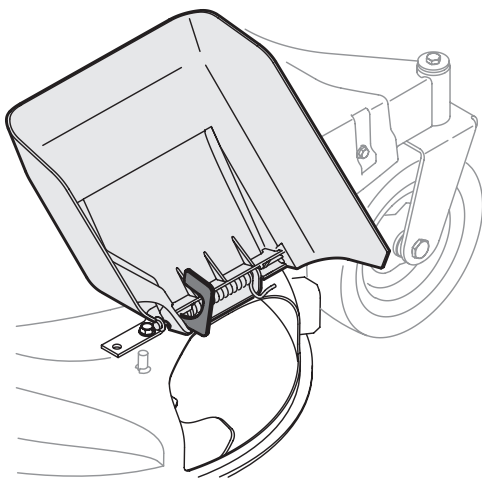

## **FAST START GUIDE**

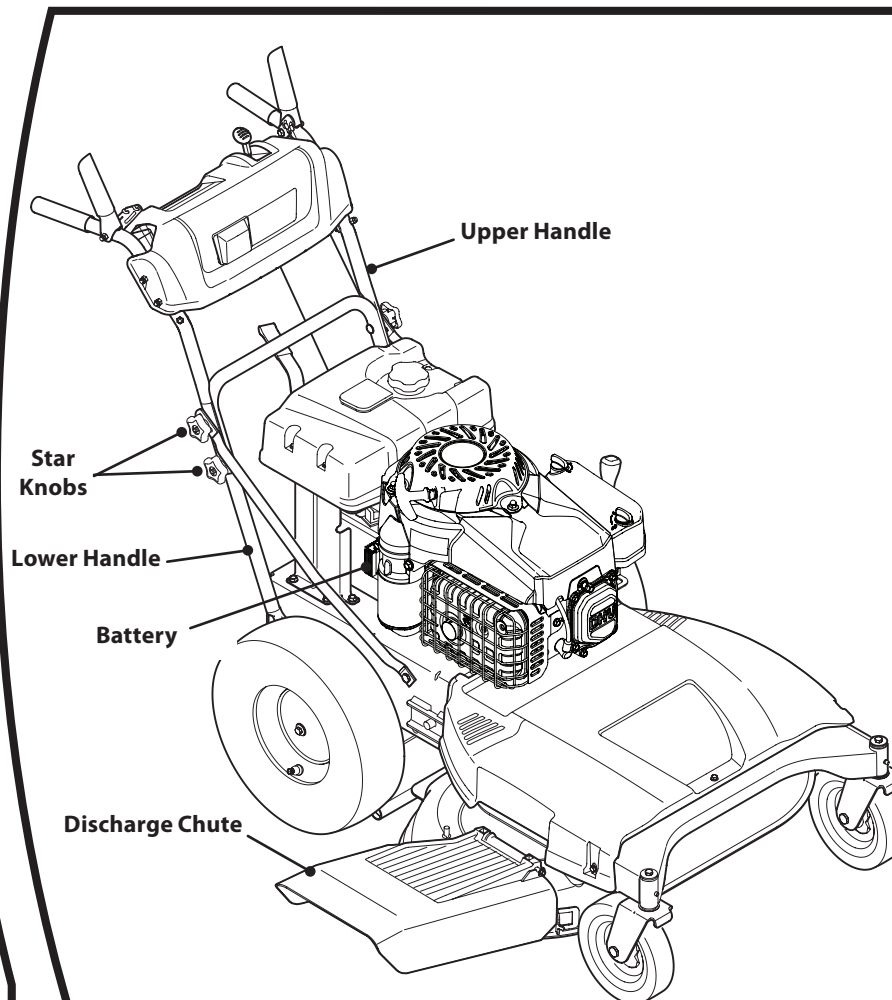

Tools Required:

- 3/8-inch wrench (or adjustable wrench)
- 7/16-inch wrench (or adjustable wrench)
- 1/2-inch wrench (or adjustable wrench)

3

Remove the lower star knobs and carriage screws from the lower handle.

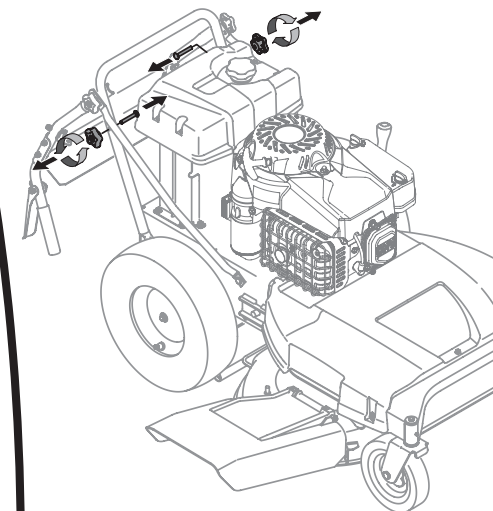

4

- A. Pivot the upper handle into the operating position.
- B. Install the carriage screws and lower star knobs removed earlier. Securely tighten *both* the upper and lower star knobs.

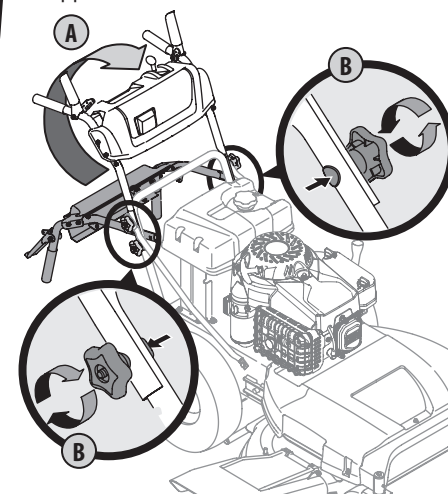

**IMPORTANT: READ OPERATOR'S MANUAL AND ENGINE MANUAL THOROUGHLY AND FOLLOW THE IMPORTANT SAFE OPERATION PRACTICES BEFORE OPERATING .**



**Need Help? Call  
1-888-TO-HELP-U**





**READ AND UNDERSTAND ALL INSTRUCTION, WARNING, AND DANGER LABELS.**  
**PARA INSTRUCCIONES EN ESPAÑOL, REFIÉRESE AL MANUAL DEL OPERADOR.**



# FAST START GUIDE

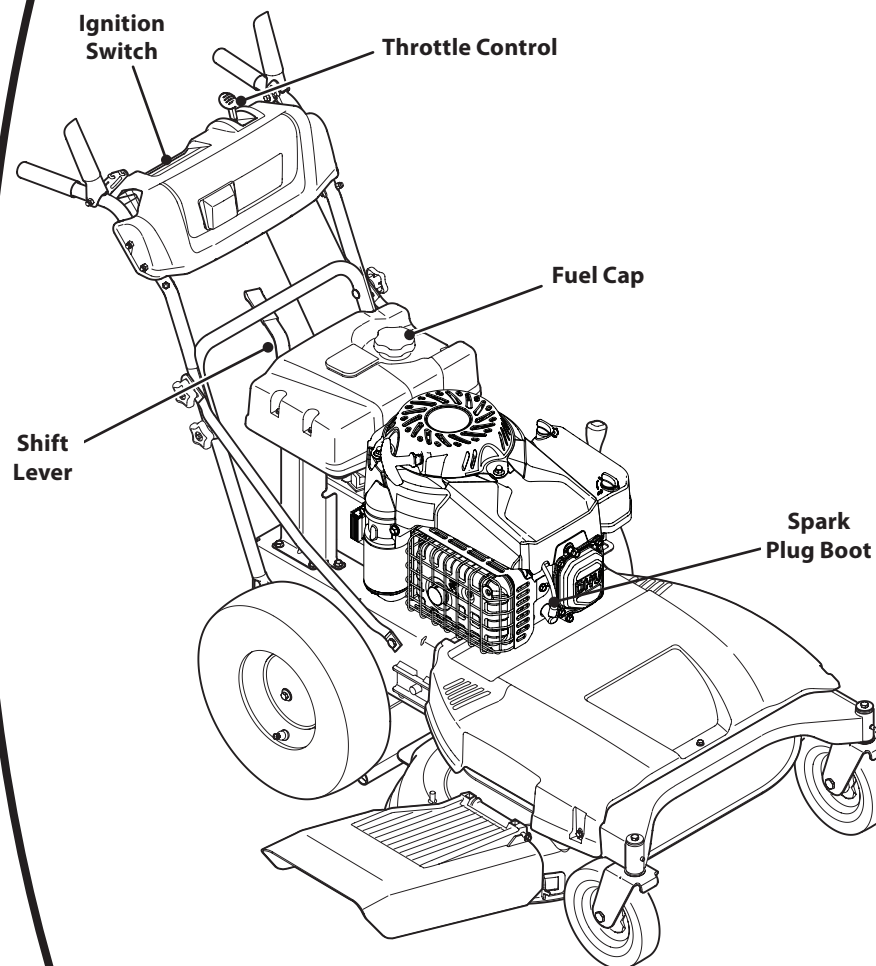

#### Tools Required:

- $\frac{3}{8}$ -inch wrench (or adjustable wrench)
- $\frac{7}{16}$ -inch wrench (or adjustable wrench)
- $\frac{1}{2}$ -inch wrench (or adjustable wrench)

5

Remove the screw and the lock nut that secures the shift lever to the shift lever plate.

Remove the remaining screw and nut from the shift lever plate.

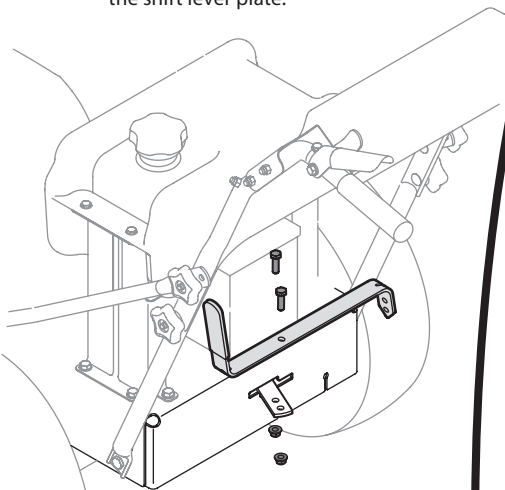

6

Reposition the shift lever (vertically), aligning its holes to the holes in the shift plate.

Secure the shift lever to the shift lever plate using the two screws and two nuts removed in Step 5.

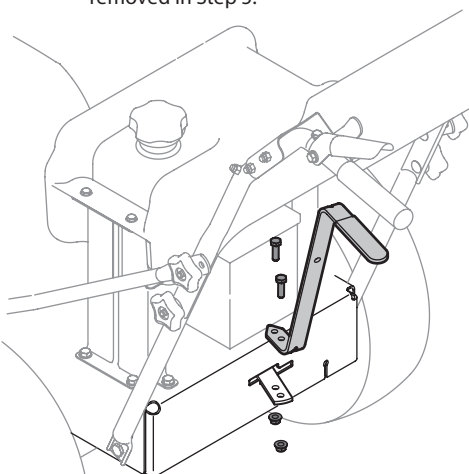

7

Fill fuel tank with clean, fresh gasoline. Do not fill above the base of fuel tank neck.

Make sure the spark plug boot is connected to the spark plug before attempting to start.

Move the throttle control into the Choke position.

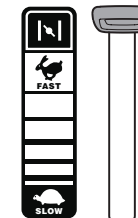

8

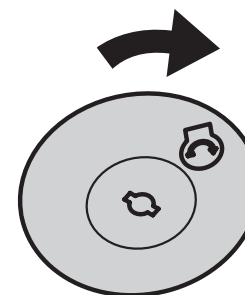

Insert the key into the ignition switch and turn it to the Start position.

Release the key after the engine starts.

9



Move the throttle control to Fast position.



**IMPORTANT: READ OPERATOR'S MANUAL AND ENGINE MANUAL THOROUGHLY AND FOLLOW THE IMPORTANT SAFE OPERATION PRACTICES BEFORE OPERATING .**



**Need Help? Call  
1-888-TO-HELP-U**

