



**READ AND UNDERSTAND ALL INSTRUCTION, WARNING, AND DANGER LABELS.**  
**PARA INSTRUCCIONES EN ESPAÑOL, REFIÉRASE AL MANUAL DEL OPERADOR.**



**1**

A. Remove the wing nuts and carriage bolts securing the upper handle to the lower handle.

B. Remove T-bolts from the handle brackets.

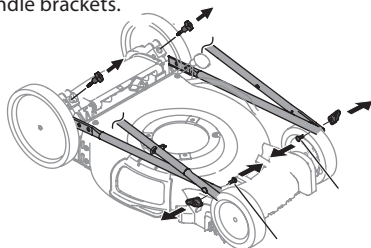

**2**

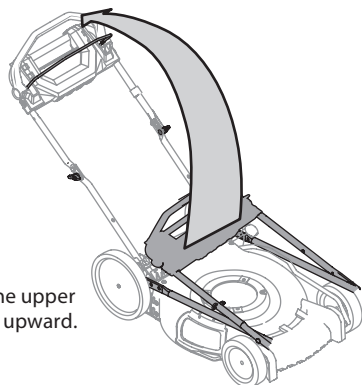

Pivot the upper handle upward.

**3**

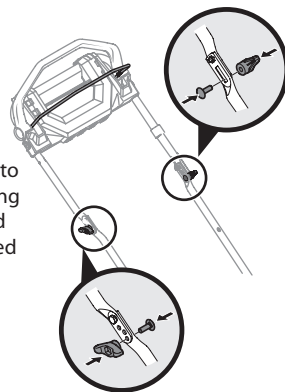

Secure upper handle to lower handle with wing nuts (**on outside**) and carriage bolts removed Step 1A.

# FAST START GUIDE

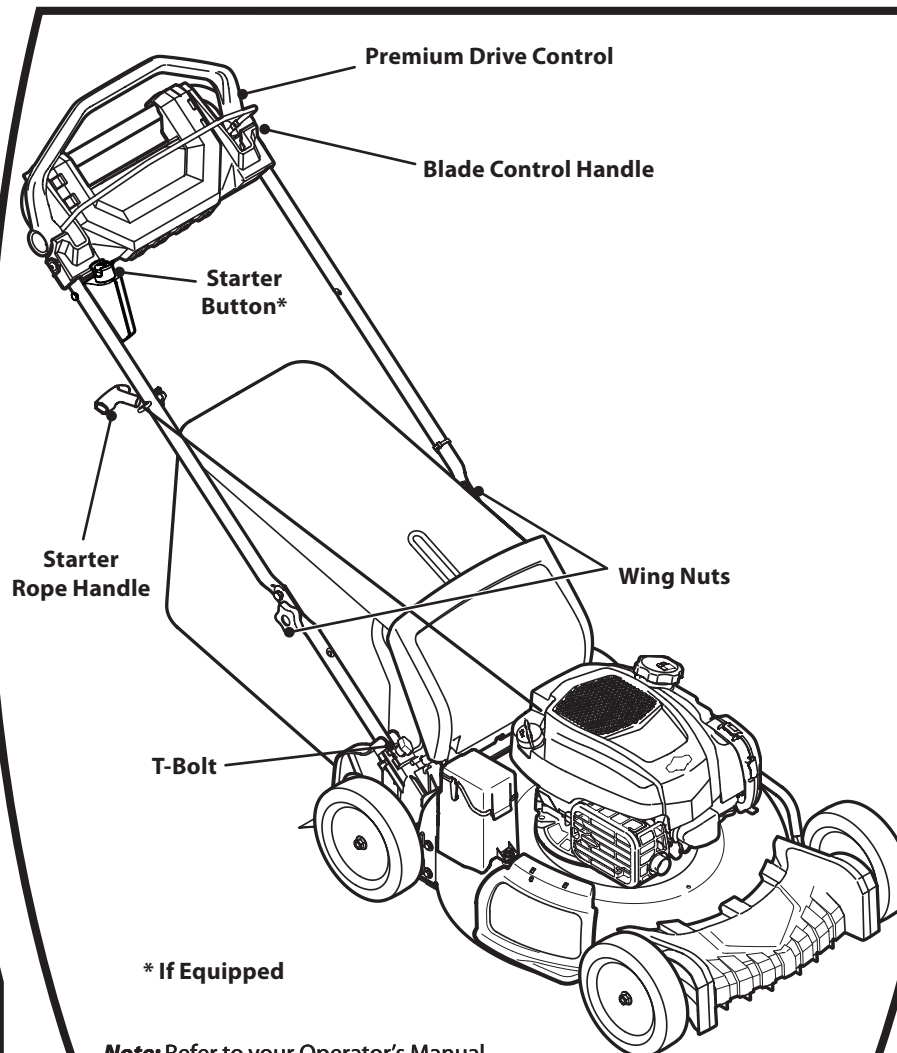

**\* If Equipped**

**Note:** Refer to your Operator's Manual for instructions on attaching the grass collector.

**4**

Insert the T-bolts removed in Step 1B through the handle brackets to secure the handle in place.

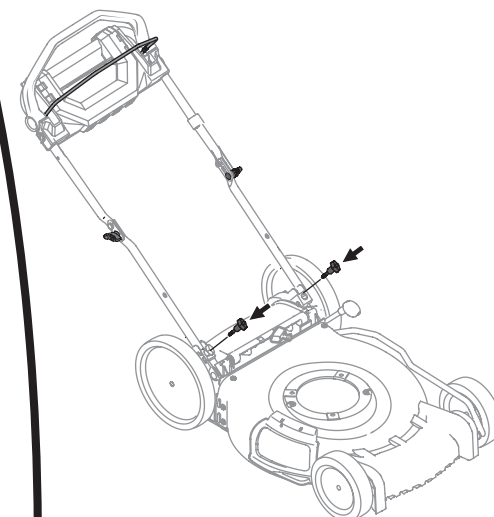

**5**

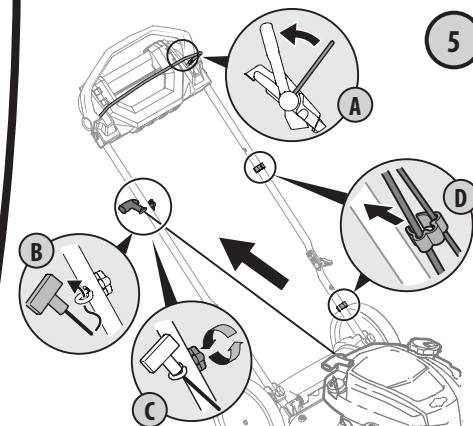

- A. Hold the blade control handle against the premium drive control.
- B. Slowly pull starter rope handle from engine and slip starter rope into the rope guide.
- C. Tighten rope guide wing knob.
- D. Use clips to secure cables to lower handle.



**IMPORTANT: READ OPERATOR'S MANUAL AND ENGINE MANUAL THOROUGHLY AND FOLLOW THE IMPORTANT SAFE OPERATION PRACTICES BEFORE OPERATING .**



**Need Help?**  
**Call 1-888-TO-HELP-U**





READ AND UNDERSTAND ALL INSTRUCTION, WARNING, AND DANGER LABELS.  
PARA INSTRUCCIONES EN ESPAÑOL, REFIÉRASE AL MANUAL DEL OPERADOR.



## **FAST START GUIDE**

5

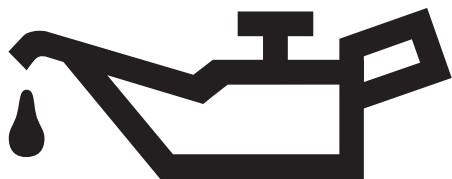

Pour the entire contents of the oil bottle (supplied) into the oil fill. Check the oil level using the dipstick. (Refer to the Operator's Manual)

6

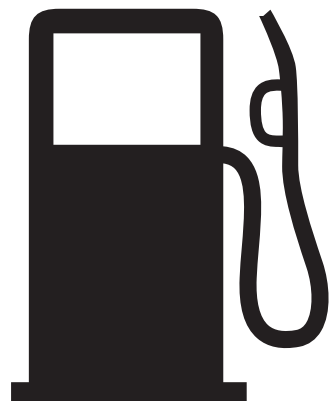

Fill fuel tank with clean, fresh gasoline. Do not fill above the base of fuel tank neck.

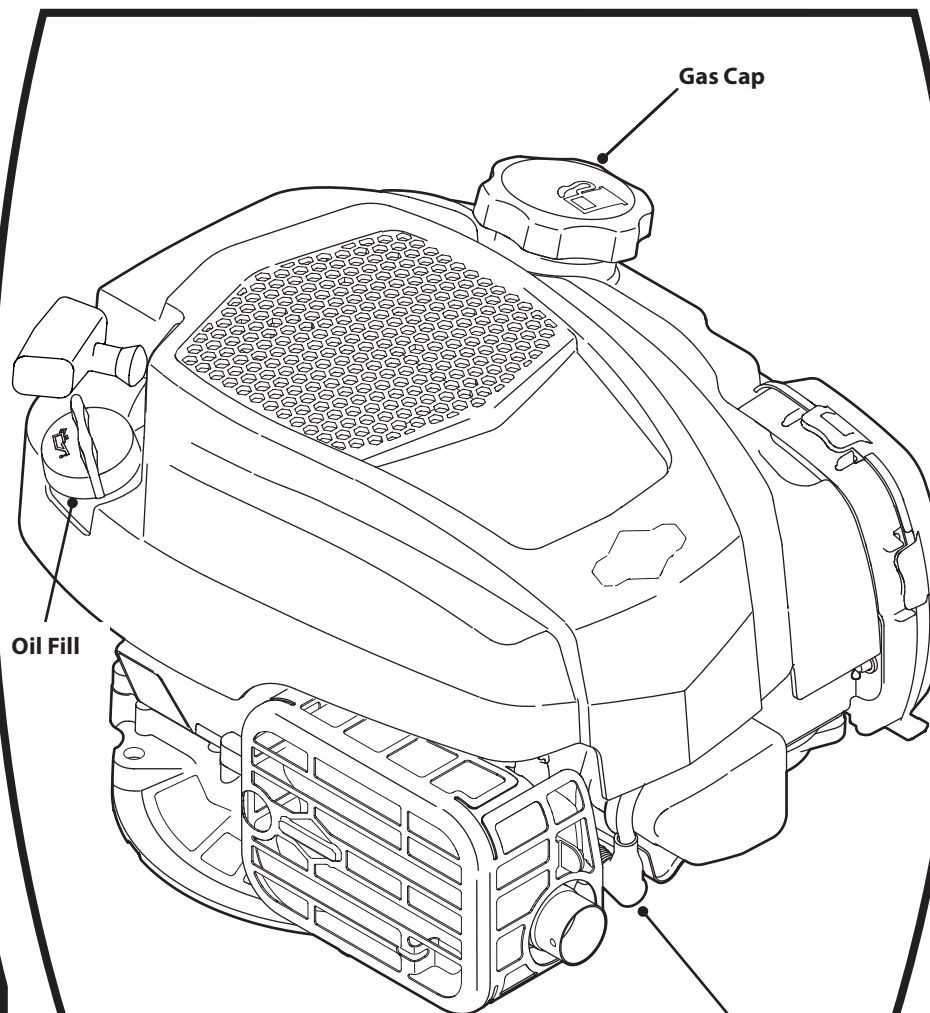

7

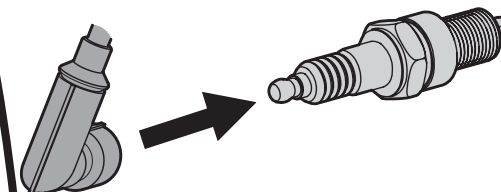

Make sure the spark plug boot is connected to the spark plug before attempting to start.

8

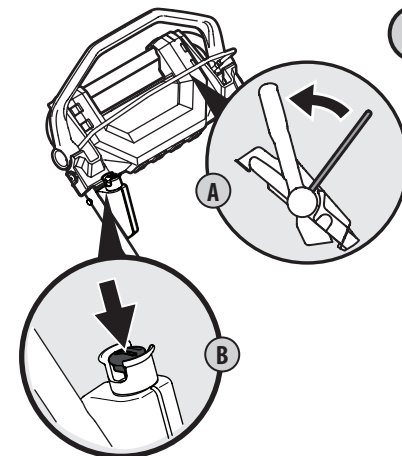

- A. While standing behind the machine, pivot the Blade Control Handle against the upper handle.
- B. Insert and push the electric starter push key to start the engine. If the engine does not start after repeated attempts, wait a few minutes and repeat.



**IMPORTANT: READ OPERATOR'S MANUAL AND ENGINE MANUAL THOROUGHLY  
AND FOLLOW THE IMPORTANT SAFE OPERATION PRACTICES BEFORE OPERATING .**



**Need Help?**  
**Call 1-888-TO-HELP-U**

