

**1**

Read the operator's manual thoroughly before operating the unit. Follow all warnings and safety instructions. This fast guide is intended as a reference for users that have already read the operator's manual and are familiar with the necessary safety precautions.

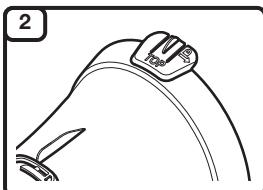

### ASSEMBLY

**2**

Set the unit on a flat, level surface. Rotate the upper blower tube so that the TOP lock tab is facing up.

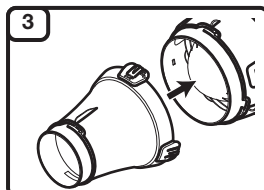

**3**

Align the TOP lock tab on the upper blower tube with the groove on the blower outlet. Push the upper blower tube onto the blower outlet.

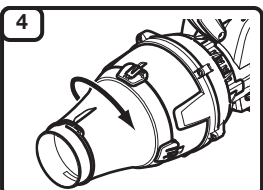

**4**

While holding the handle firmly, turn the upper blower tube clockwise until it locks into place. The tab on the upper blower tube should align with the tab on the blower outlet. Press all three lock tabs to make sure they are fully locked in place.

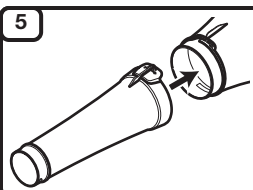

**5**

Align the tab on the lower blower tube with the groove on the upper blower tube. Push the lower blower tube onto the upper blower tube.

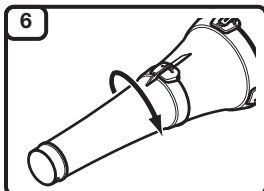

**6**

While holding the handle firmly, turn the lower blower tube clockwise until it locks into place. The tab on the lower blower tube should align with the tab on the upper blower tube.

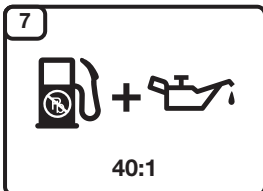

**7**

Mix thoroughly in a separate fuel can:  
 - 3.2 fl. oz. of 2-cycle engine oil  
 - 1 gallon of fresh unleaded gasoline (**less than 30 days old**)  
**NOTE:** Do not mix directly in the unit fuel tank.

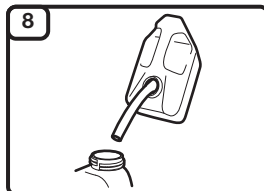

**8**

Position the unit with the fuel cap facing up. Slowly remove the fuel cap. Fill the fuel tank. Reinstall the fuel cap. Move the unit at least 30 ft. (9.1 m) from the fuel container and the fueling site before starting the engine.

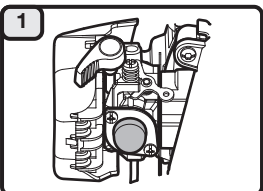

### STARTING

**1**

Slowly press and release the primer bulb **10 times**.

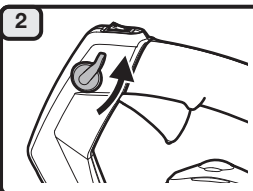

**2**

Move the cruise control to the **LO (slow)** position.

**NOTE:** Keep the cruise control in the **LO (slow)** position and **DO NOT** squeeze the throttle control until step 7.

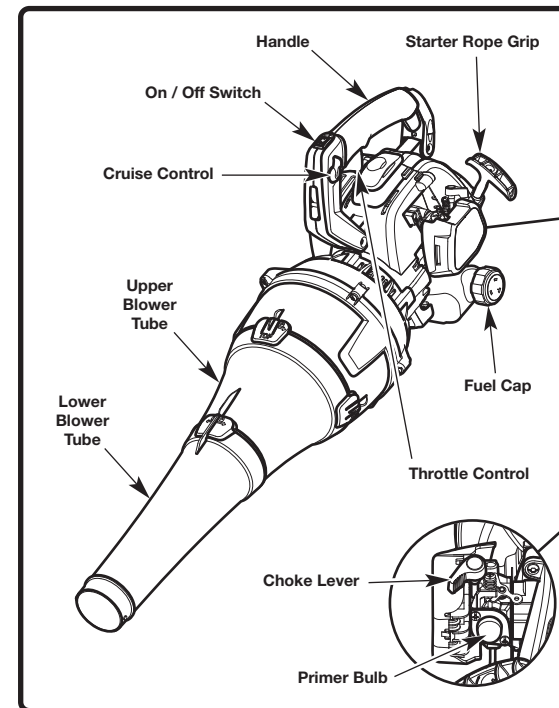

**NO ASSEMBLY TOOLS REQUIRED**

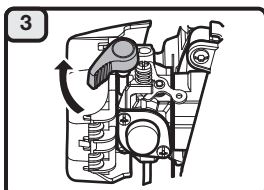

**3**

Flip the choke lever clockwise until it clicks.

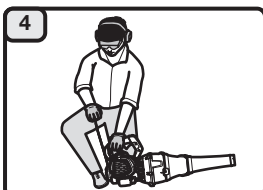

**4**

Crouch in the starting position.

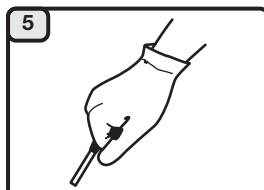

**5**

Pull the starter rope with a controlled and steady motion until the unit starts.



**6**

Idle the engine for 30 seconds.

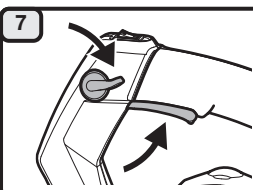

**7**

Squeeze and hold the throttle control or move the cruise control to the **HI (fast)** position.

Allow the engine to warm up for 30 to 60 seconds. The unit may be used during this time.

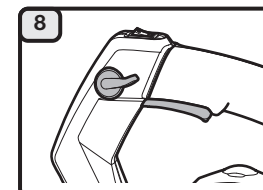

**8**

**NOTE:** Once the engine is properly warmed, the cruise control may be adjusted and the throttle control can be used normally.

### DIDN'T START?

If the engine does not start after pulling the starter rope 10 times, repeat the starting procedure.

If the unit still fails to start, refer to the operator's manual for additional starting and troubleshooting information.



**IMPORTANT: READ THE OPERATOR'S MANUAL THOROUGHLY AND FOLLOW THE SAFE OPERATION PRACTICES WHILE OPERATING THE UNIT.**

Lea la traducción en Español en el manual.